

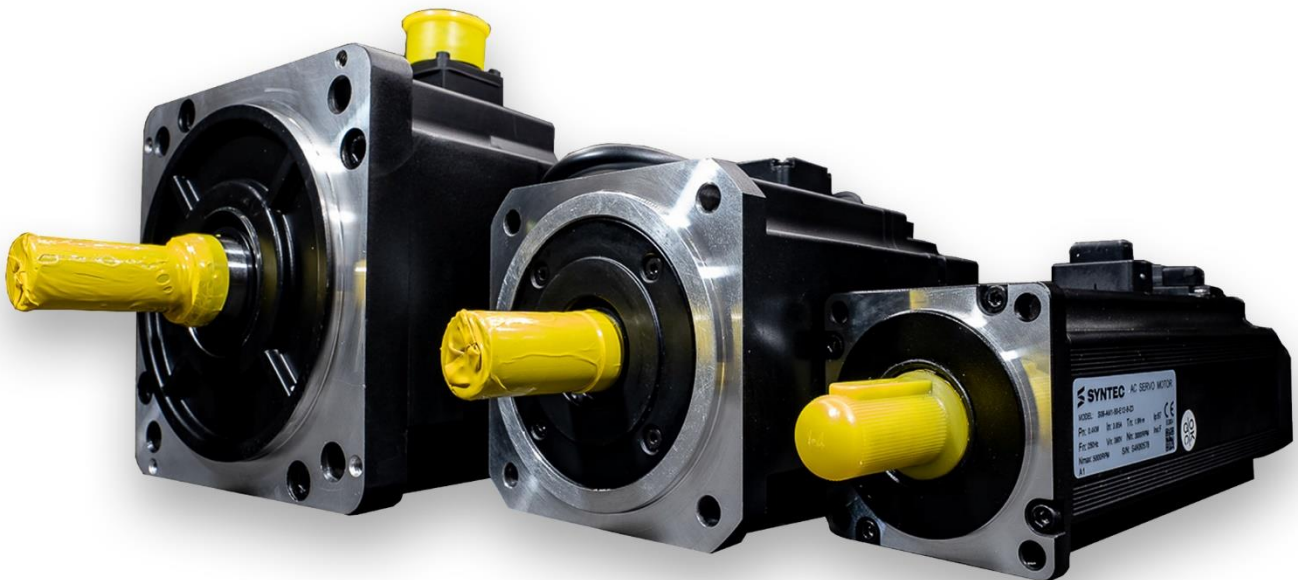

Syntec Servo Catalog



Contents

Topic	Page
Specification	5
220V Class	5
380V Class	6
Dimensions & Torque-speed curve	8
F Series	8
• S08-AM3-60□-F4	8
• S08-AM5-40□-F3	9
• S08-AM8-40□-F3	10
• S08-AM11-40□-F3	11
• S08-AM11-30B□-F4	12
• S08-AM15-40□-F3	13
• S08-AM18-40□-F4	14
• S08-AM18-30B-F4	15
• S08-AM28-40□-F4	16
• S08-AM35-20□-F4	17
• S08-AM48-20□-F4	18
• S08-AM35-20□-F5	19
S08-AM48-20□-F5	20
• S08-AM8-50K-F1	21
• S08-AM11-50K-F1	22
Z Series	23
• S08 - AM03 - 50□ – Z3	23
• S08 - AM06 - 50□ – Z3	24
• S08 – AM1 - 60□ – Z4	25
• S08 – AM1 - 50□ – Z3	26
• S08 – AM2 - 60□ – Z4	27

Contents

Topic	Page
• S08 – AM3 - 50□ – Z3	28
H Series	29
• S08 - AM03 - 50□ - H1	29
• S08 - AM03 - 50□ – H3	30
• S08 - AM06 - 50□ – H1	31
• S08 – AM06-50□-H3	32
• S08 – AM1-50□-H1	33
• S08 – AM1-50□-H2	34
• S08 – AM1-50□-H3	35
• S08 – AM2-50□-H1	36
• S08 – AM2-50□-H2	37
• S08 – AM2-50□-H3	38
• S08 – AM4-40□-H2	39
• S08 – AM5-40□-H1	40
• S08 – AM7-25□-H2	41
• S08 – AM7-30□-H2	42
• S08 – AM8-30□-H1	43
• S08 – AM9-30□-H2	44
• S08 – AM11-30□-H1	45
Table of Motors and Applicable Drive	46
220V Class	46
○ H Series	46
380V Class	49
○ F Series	49
○ Z series	52

Model Designations

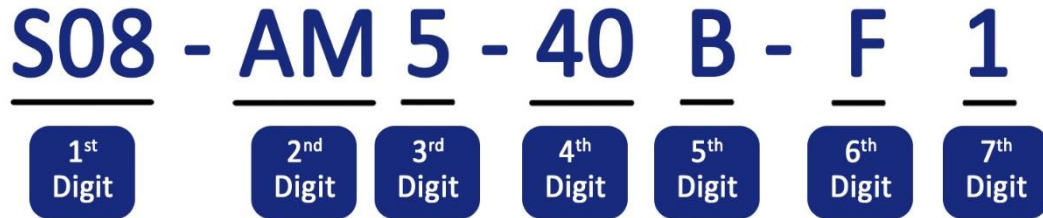

1st Digit Servo product

2nd Digit Axial Motor

3rd Digit Rated Torque (Nm)

CODE	Specifications	Rated Power
03	0.3 Nm	0.1 kW
06	0.6 Nm	0.2 kW
1	1 Nm	0.4 kW
2	2 Nm	0.8 kW
3	3 Nm	1.0 kW
5	5 Nm	1.1 kW
8	8 Nm	1.7 kW
11	11 Nm	2.4 kW
15	15 Nm	3.1 kW
18	18 Nm	3.9 kW
28	28 Nm	5.9 kW
35	35 Nm	5.5 kW
48	48 Nm	7.5 kW

7th Digit Version Number

4th Digit Maximum Speed (rpm)

CODE	Specifications
20	2000 rpm
30	3000 rpm
40	4000 rpm
50	5000 rpm
60	6000 rpm

5th Digit Optional Accessories

CODE	Specifications
B	Break
S	Sealing
K	Keyway
BS	Break + Sealing + Keyway
BK	Break + Keyway
SK	Sealing + Keyway
BSK	Break + Sealing + Keyway

6th Digit Model Series

CODE	Specifications
F	FUKUTA
M	MIGE
Z	Grand Sail
H	HCFA

Specification

220V Class

○ H Series

220V Axial Motor		Rated Power	Rated Torque	Max. Torque	Rated Current	Rated Speed	Max, Speed	Rotor Inertial (I): with Break	Encoder
Model Number									
S08-AM□□ - □□□ - □□		kW	N . m		Arms	rpm		Kg . cm ²	-
IP65 Protect Level									
H Series	AM03-50□-H1	0.1	0.32	1.12	0.8	3000	5000	0.77	Hcfa 17bit
	AM03-50B□-H1	0.1	0.32	1.12	0.8	3000	5000	0.093	
	AM06-50□-H1	0.2	0.64	1.91	1.7	3000	5000	0.43	
	AM06-50B□-H1	0.2	0.64	1.91	1.7	3000	5000	0.47	
	AM1-50□-H1	0.4	1.27	3.82	2.7	3000	5000	0.69	
	AM1-50B□-H1	0.4	1.27	3.82	2.7	3000	5000	0.72	
	AM1-50□-H2	0.4	1.27	4.46	2.1	3000	5000	0.56	
	AM1-50B□-H2	0.4	1.27	4.46	2.1	3000	5000	0.58	
	AM2-50□-H1	0.75	2.39	7.1	4.3	3000	5000	1.59	
	AM2-50B□-H1	0.75	2.39	7.1	4.3	3000	5000	1.78	
	AM2-50□-H2	0.75	2.39	8.36	3.8	3000	5000	1.56	
	AM2-50B□-H2	0.75	2.39	8.36	3.8	3000	5000	1.66	
	AM4-40□-H2	1	4.77	14.31	5.92	2000	4000	13.9	
	AM4-40B□-H2	1	4.77	14.31	5.92	2000	4000	16	
	AM7-30□-H2	1.5	7.16	21.48	8.3	2000	3000	19.9	
	AM7-30B□-H2	1.5	7.16	21.48	8.3	2000	3000	22	
AM9-30□-H2	2	9.55	28.56	12.9	2000	3000	26		
AM9-30B□-H2	2	9.55	28.56	12.9	2000	3000	28.1		
IP67 Protect Level									
H Series	AM03-50□-H3	0.1	0.32	1.1	1.1	3000	5000	0.071	Hcfa 17bit
	AM03-50B□-H3	0.1	0.32	1.1	1.1	3000	5000	0.074	
	AM06-50□-H3	0.2	0.64	2.23	1.4	3000	5000	0.29	
	AM06-50B□-H3	0.2	0.64	2.23	1.4	3000	5000	0.31	
	AM1-50□-H3	0.4	1.27	4.46	2.1	3000	5000	0.56	
	AM1-50B□-H3	0.4	1.27	4.46	2.1	3000	5000	0.58	
	AM02-50□-H3	0.75	2.39	8.36	3.8	3000	5000	1.56	
	AM02-50B□-H3	0.75	2.39	8.36	3.8	3000	5000	1.66	
	AM7-25□-H2	1.5	7.2	21.6	6	2000	2500	20	
	AM7-25B□-H2	1.5	7.2	21.6	6	2000	2500	21.2	

380V Class

○ F Series

380V Axial Motor		Rated Power	Rated Torque	Max. Torque	Rated Current	Rated Speed	Max, Speed	Rotor Inertial	Encoder
Model Number									
S08-AM□□ - □□□ - □□		kW	N . m		Arms	rpm		Kg . cm ²	-
IP67 Protect Level									
F Series	AM3-60□-F4	1	3.2	10	4.25	3000	6000	3.5	Nikon 24bit
	AM3-60B□-F4	1	3.2	10	4.25	3000	6000	3.85	
	AM5-40□-F3	1.1	5.39	14.9	4.17	2000	4000	13.3	
	AM5-40B□-F3	1.1	5.39	14.9	4.17	2000	4000	16	
	AM8-40□- F3	1.7	8.34	30.8	6.44	2000	4000	20.6	
	AM8-40B□- F3	1.7	8.34	30.8	6.44	2000	4000	23.3	
	AM11-40□- F3	2.4	11.5	34	8.27	2000	4000	26.3	
	AM11-40B□- F3	2.4	11.5	34	8.27	2000	4000	28.9	
	AM11-30B- F4	2.4	11.5	34	5.7	2000	3000	28.9	
	AM15-40□-F3	3.1	15	45	9.2	2000	4000	32.8	
	AM15-40B□-F3	3.1	15	45	9.2	2000	4000	35.5	
	AM18-40□-F4	3.9	18.6	48.5	11	2000	4000	46	
	AM18-40B□-F4	3.9	18.6	48.5	11	2000	4000	51.8	
	AM18-30B-F4	3.9	18.6	45.3	9.7	2000	3000	51.8	
	AM28-30□-F4	5.9	28.4	76	13.6	2000	3000	69	
	AM28-30B□-F4	5.9	28.4	76	13.6	2000	3000	74.8	
	AM35-20□-F4	5.5	35	91.4	11.9	1500	2000	90.5	
	AM35-20B□-F4	5.5	35	91.4	11.9	1500	2000	108	
	AM35-20□-F5	5.5	35	91.4	11.9	1500	2000	90.5	
	AM35-20B□-F5	5.5	35	91.4	11.9	1500	2000	108	
AM48-20□-F4	7.5	48	120.9	16.5	1500	2000	125		
AM48-20B□-F4	7.5	48	120.9	16.5	1500	2000	140		
AM48-20□-F5	7.5	48	120.9	16.5	1500	2000	125		
AM48-20B□-F5	7.5	48	120.9	16.5	1500	2000	140		
F Series (Unit-Head)	AM8-50K-F1	1.7	8	24	6	2000	5000	19	Syntec 18bit
	AM11-50K-F1	2.3	11	45	7.6	2000	5000	31.6	

○ Z Series

380V Axial Motor		Rated Power	Rated Torque	Max. Torque	Rated Current	Rated Speed	Max, Speed	Rotor Inertial (): with Break	Encoder
Model Number									
S08-AM□□ - □□□ - □□		kW	N . m		Arms	rpm		Kg . cm ²	-
IP67 Protect Level									
Z Series	AM03-50□-Z3	0.1	0.32	0.96	1.4	3000	5000	0.045	Nikon 24bit
	AM03-50□-Z3	0.1	0.32	0.96	1.4	3000	5000	0.05	
	AM06-50□-Z3	0.2	0.64	1.92	1.9	3000	5000	0.16	
	AM06-50□-Z3	0.2	0.64	1.92	1.9	3000	5000	0.18	
	AM1-60□-Z4	0.4	1.27	3.8	2.9	3000	6000	0.54	
	AM1-60□-Z4	0.4	1.27	3.8	2.9	3000	6000	0.55	
	AM1-50□-Z3	0.4	1.9	5.7	3.85	3000	5000	0.57	
	AM1-50□-Z3	0.4	1.9	5.7	3.85	3000	5000	0.6	
	AM2-60□-Z4	0.75	2.39	7.2	5.1	3000	6000	1.7	
	AM2-60□-Z4	0.75	2.39	7.2	5.1	3000	6000	1.8	
	AM3-50□-Z3	1	3.18	9.54	5.4	3000	5000	1.9	
	AM3-50□-Z3	1	3.18	9.54	5.4	3000	5000	2	

Dimensions & Torque-speed curve

F Series

- S08-AM3-60□-F4

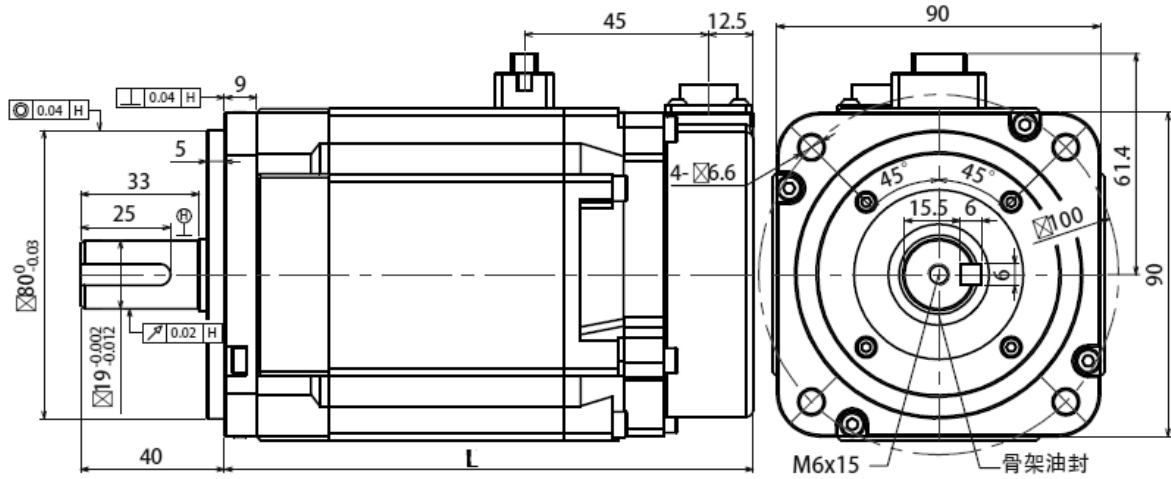

Torque-Motor Speed Characteristics

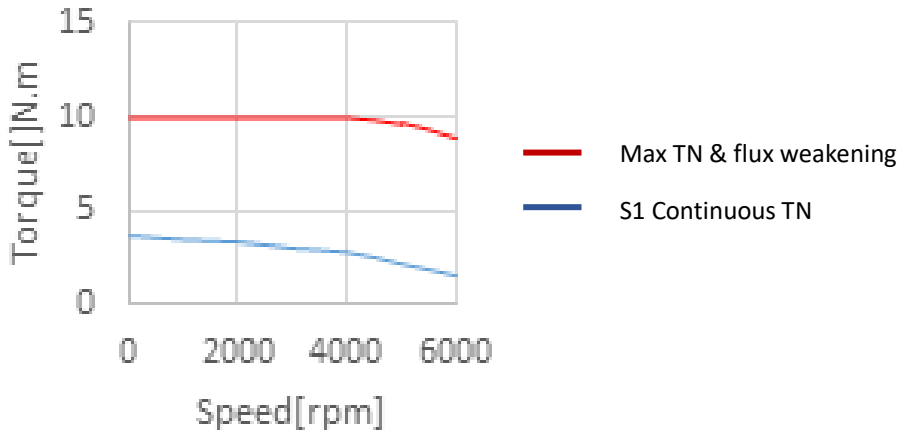

Model	Frame Size	Name	Power (KW)	Motor Length (mm)	Shaft Diameter (mm)	Shaft End Spec.(mm)			
						Keyway Width	Keyway Length	Keyway Depth	Screw Thread
S08-AM3-60□-F4	90	AM3	1	141	19	6	25	3	M6*15
S08-AM3-60B□-F1				182		6	25	3	M6*15

• S08-AM5-40□-F3

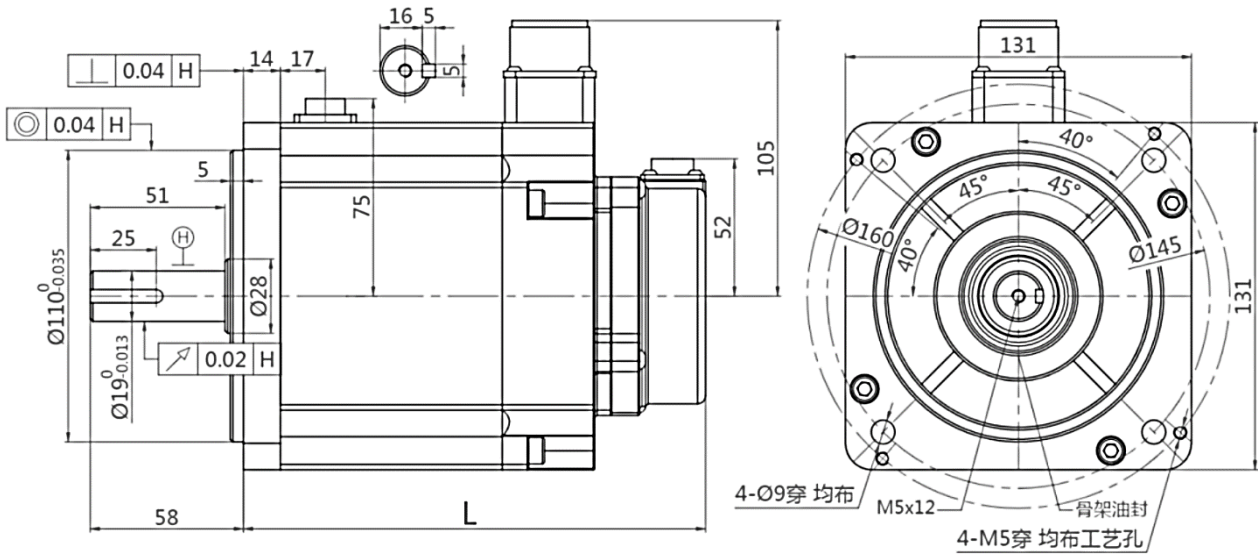

Torque-Motor Speed Characteristics

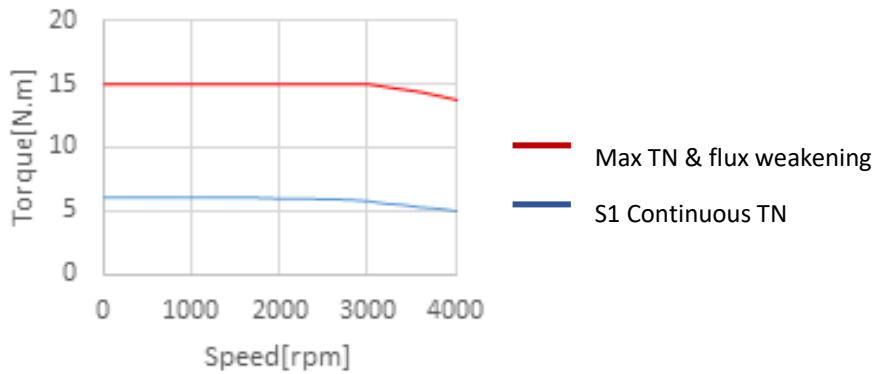

Model	Frame Size	Name	Power (KW)	Motor Length (mm)	Shaft Diameter (mm)	Shaft End Spec.(mm)			
						Keyway Width	Keyway Length	Keyway Depth	Screw Thread
S08-AM5-40□-F3	130	AM5	1.1	143	19	5	25	3	M5*12
S08-AM5-40B□-F3				175		5	25	3	M5*12

• S08-AM8-40□-F3

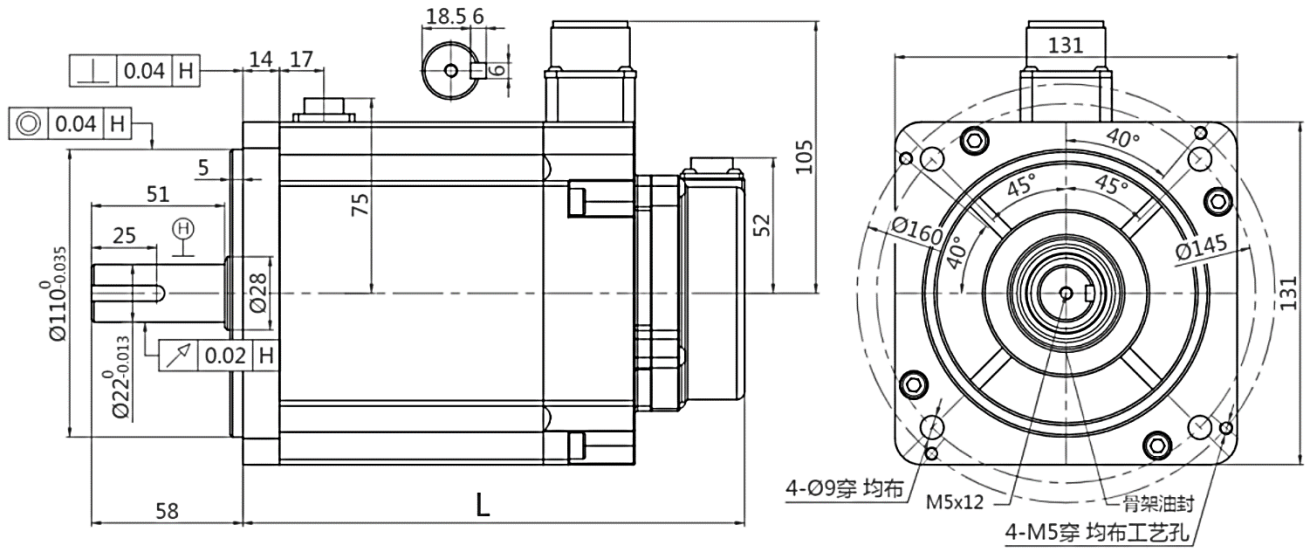

Torque-Motor Speed Characteristics

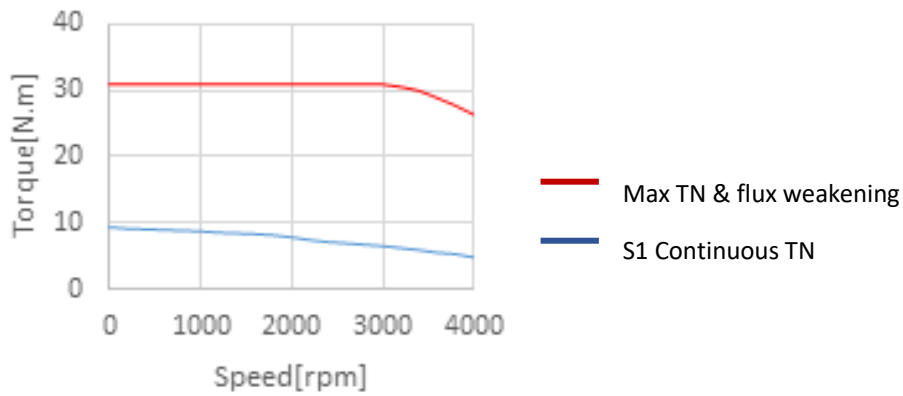

Model	Frame Size	Name	Power (KW)	Motor Length (mm)	Shaft Diameter (mm)	Shaft End Spec.(mm)			
						Keyway Width	Keyway Length	Keyway Depth	Screw Thread
S08-AM8-40□-F3	131	AM8	1.7	164	22	6	25	3.5	M5*12
S08-AM8-40B□-F3				192		6	25	3.5	M5*12

• S08-AM11-40□-F3

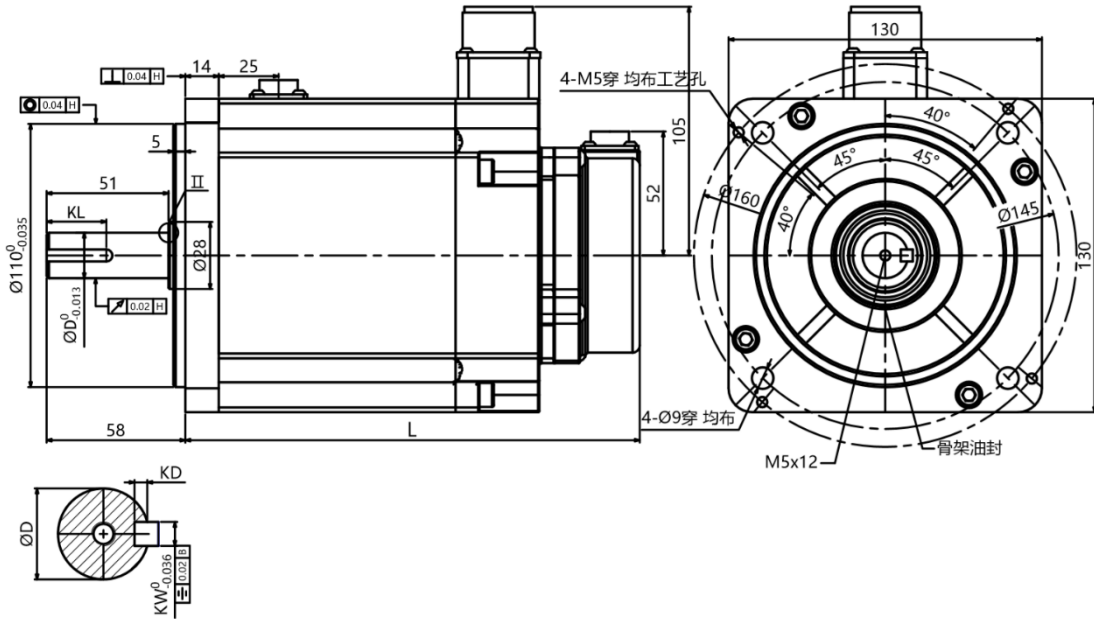

Torque-Motor Speed Characteristics

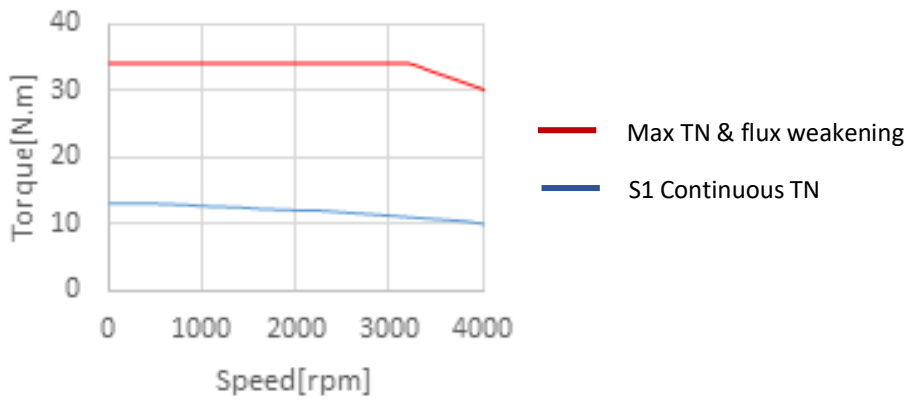

Model	Frame Size	Name	Power (KW)	Motor Length (mm)	Shaft Diameter (mm)	Shaft End Spec.(mm)			
						Keyway Width	Keyway Length	Keyway Depth	Screw Thread
S08-AM11-40□-F3	130	AM11	2.4	185.5	24	8	25	4	M5*12
S08-AM11-40B□-F3				235		8	25	4	M5*12

• S08-AM11-30B□-F4

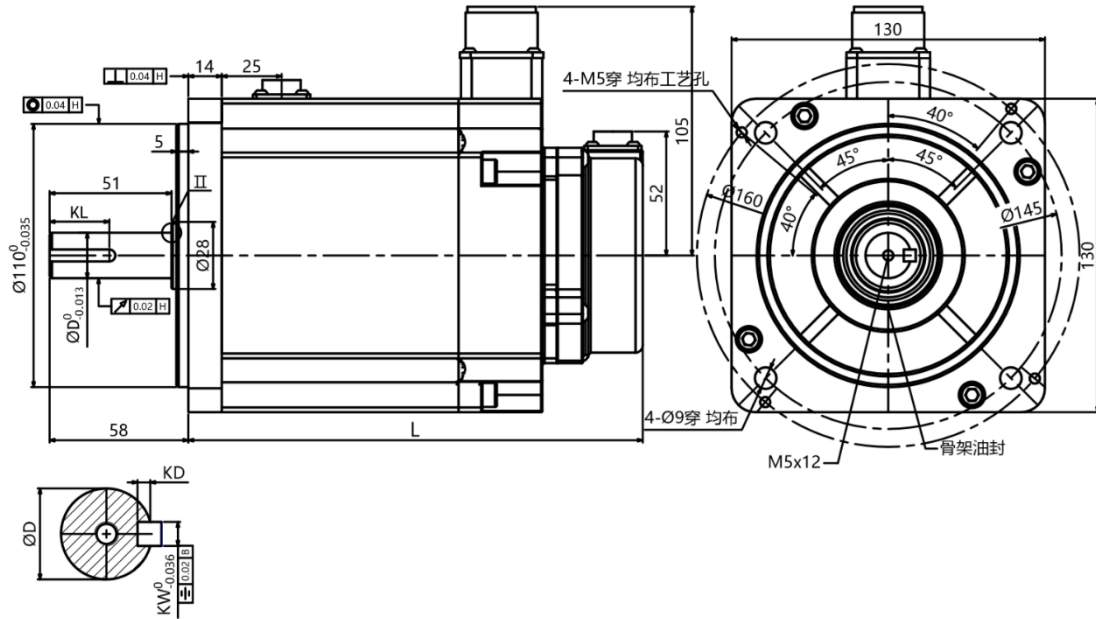

Torque-Motor Speed Characteristics

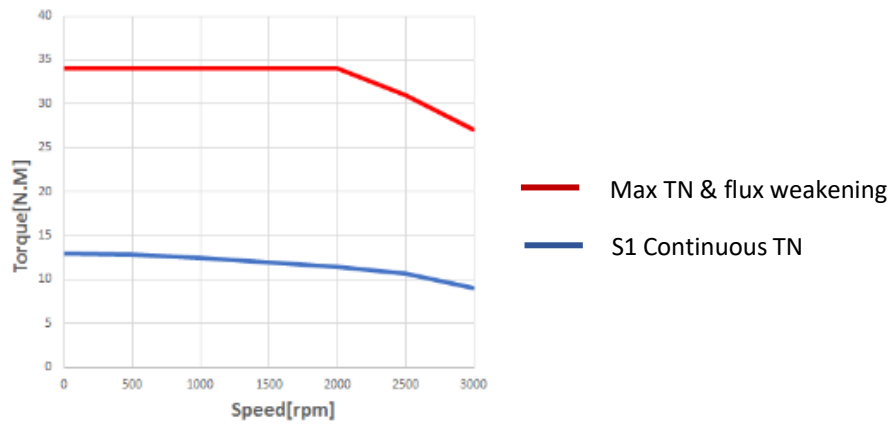

Model	Frame Size	Name	Power (KW)	Motor Length (mm)	Shaft Diameter (mm)	Shaft End Spec.(mm)			
						Keyway Width	Keyway Length	Keyway Depth	Screw Thread
S08-AM11-30B□-F3	130	AM11	2.4	213	24	8	25	4	M5*12

• S08-AM15-40□-F3

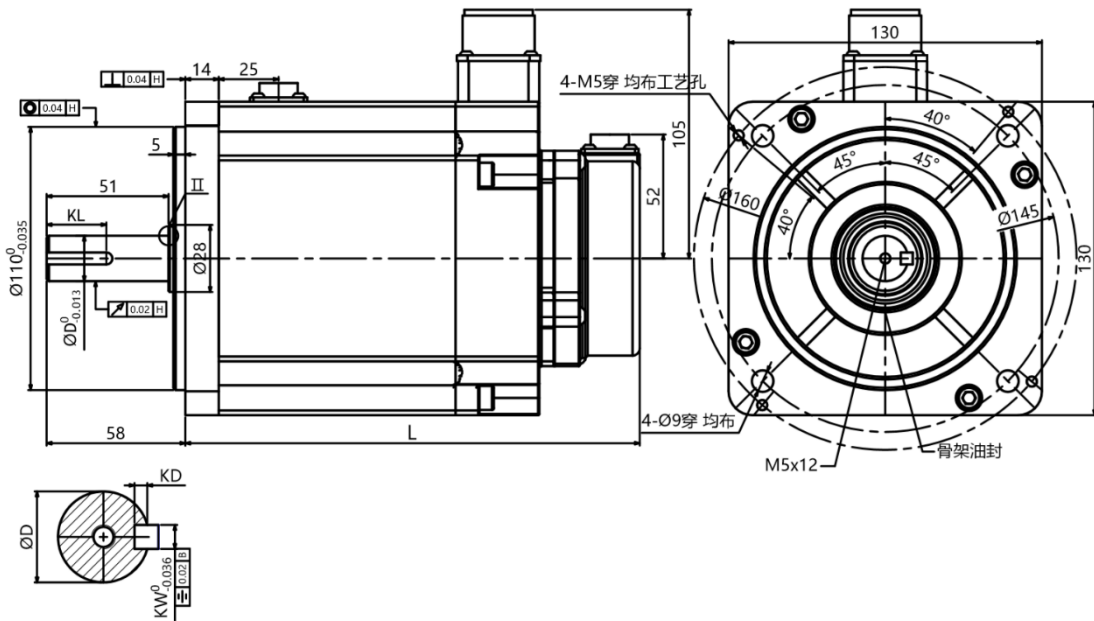

Torque-Motor Speed Characteristics

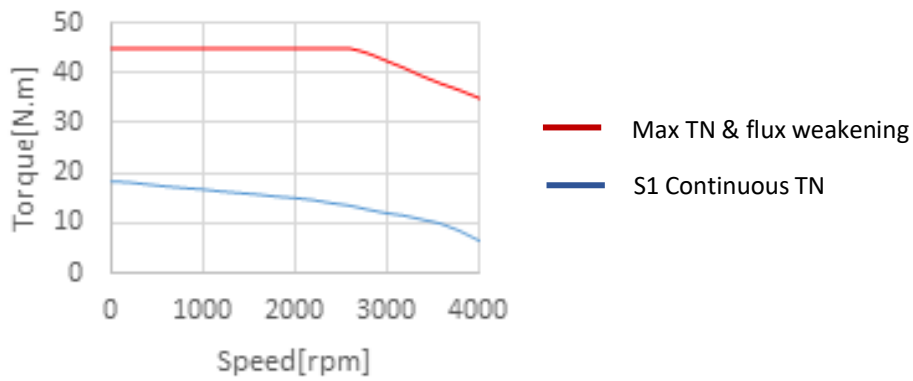

Model	Frame Size	Name	Power (KW)	Motor Length (mm)	Shaft Diameter (mm)	Shaft End Spec.(mm)			
						Keyway Width	Keyway Length	Keyway Depth	Screw Thread
S08-AM15-40□-F3	130	AM11	3.1	207	24	8	25	4	M5*12
S08-AM15-40B□-F3				235		8	25	4	M5*12

- S08-AM18-40□-F4

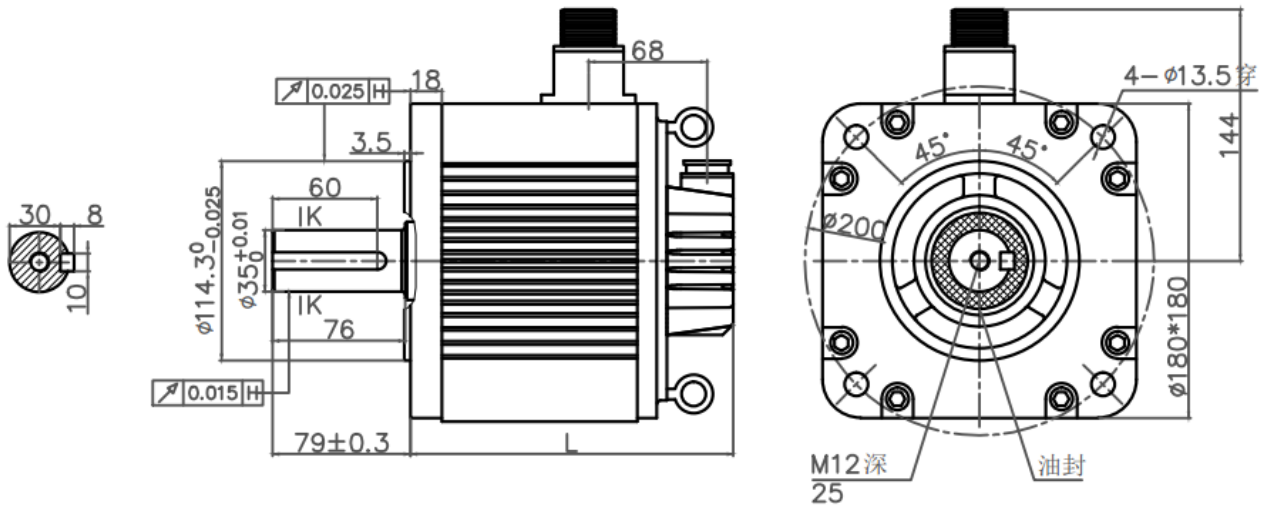

Torque-Motor Speed Characteristics

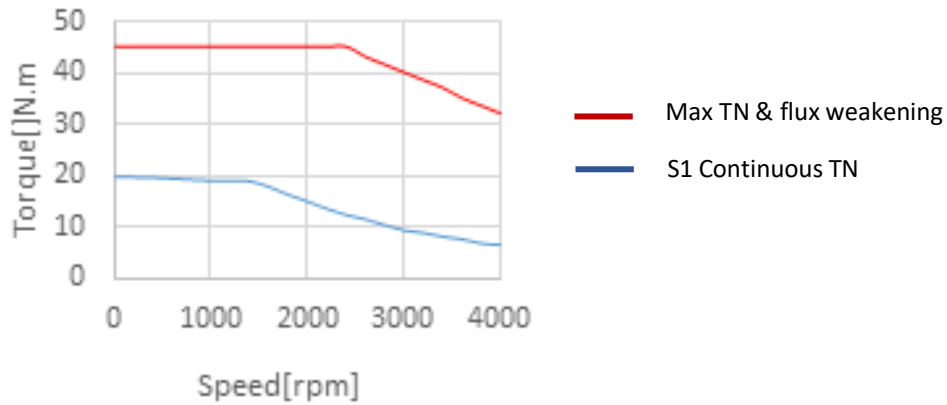

Model	Frame Size	Name	Power (KW)	Motor Length (mm)	Shaft Diameter (mm)	Shaft End Spec.(mm)			
						Keyway Width	Keyway Length	Keyway Depth	Screw Thread
S08-AM18-40□-F4	180	AM18	3.9	164.5	35	10	60	5	M12*25
S08-AM18-40B□-F4				212.5		10	60	5	M12*25

- S08-AM18-30B-F4

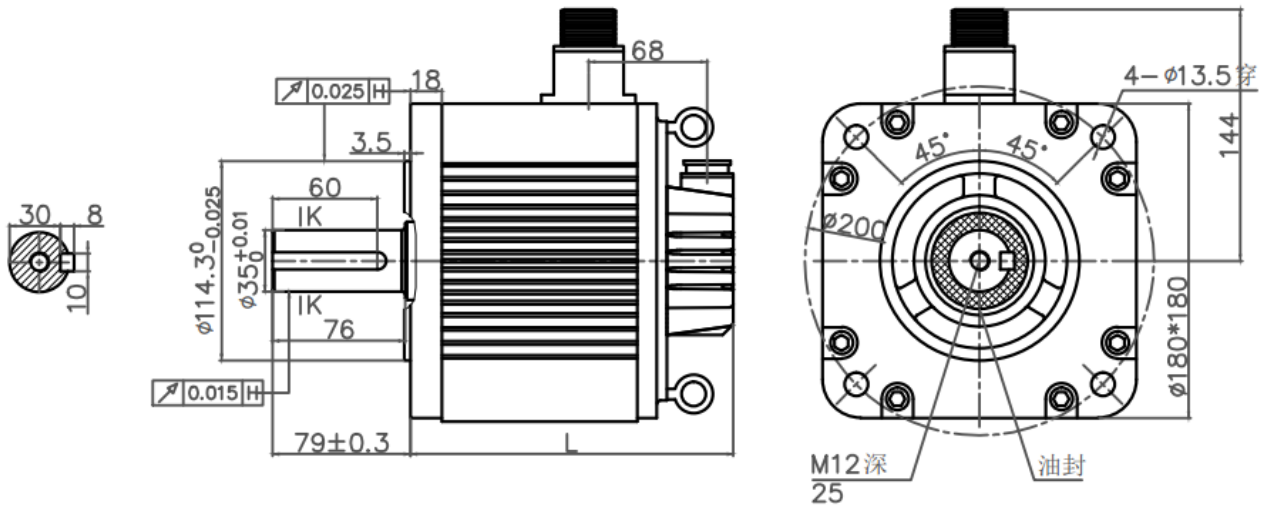

Torque-Motor Speed Characteristics

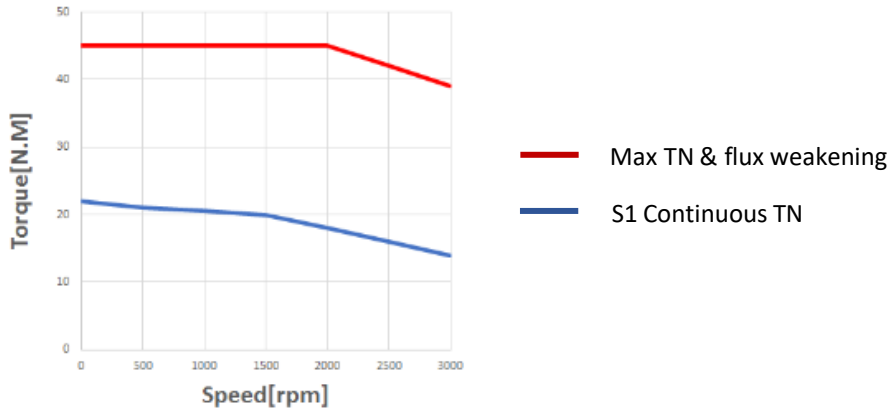

Model	Frame Size	Name	Power (KW)	Motor Length (mm)	Shaft Diameter (mm)	Shaft End Spec.(mm)			
						Keyway Width	Keyway Length	Keyway Depth	Screw Thread
S08-AM18-30B-F4	180	AM18	3.9	212.5	35	10	60	5	M12*25

- S08-AM28-40□-F4

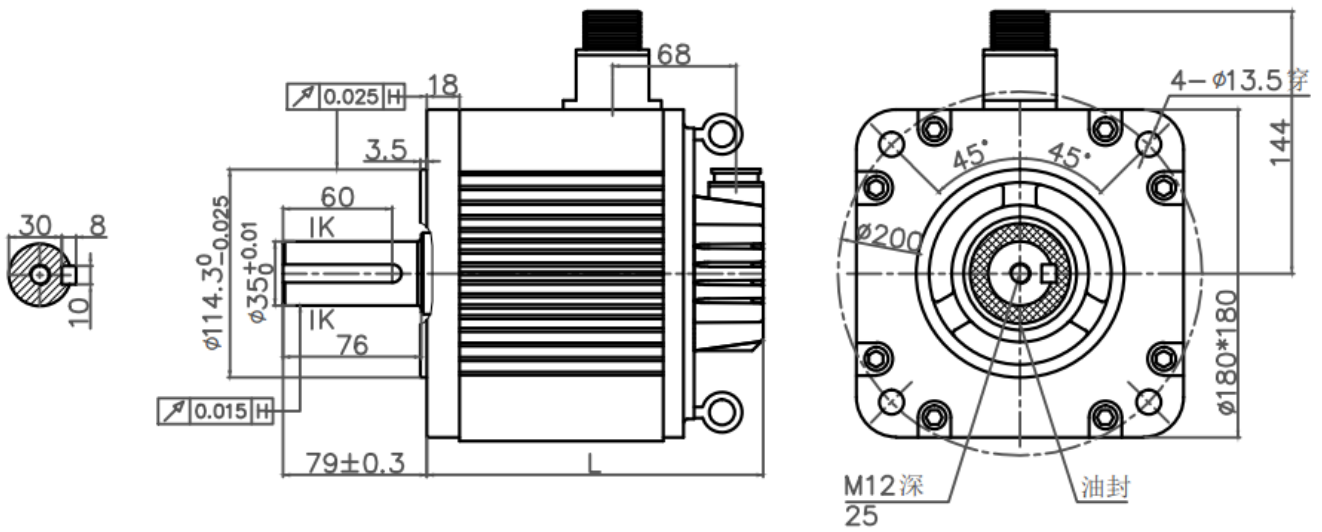

Torque-Motor Speed Characteristics

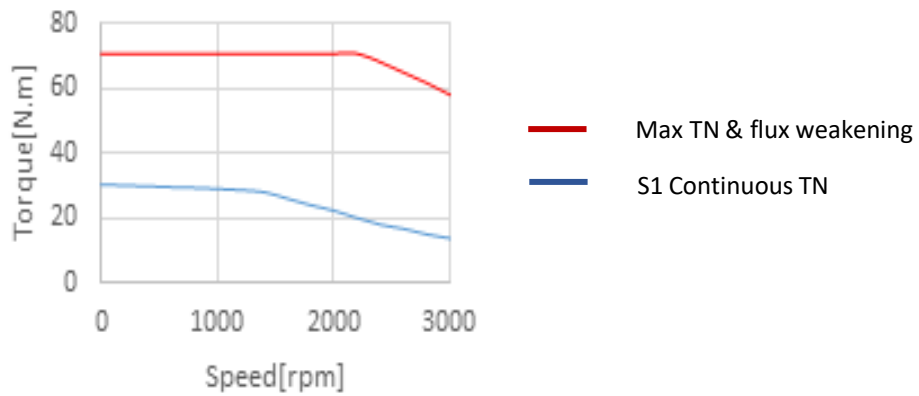

Model	Frame Size	Name	Power (KW)	Motor Length (mm)	Shaft Diameter (mm)	Shaft End Spec.(mm)			
						Keyway Width	Keyway Length	Keyway Depth	Screw Thread
S08-AM28-40□-F4	180	AM28	5.9	191	35	10	60	5	M12*25
S08-AM28-40B□-F4				239		10	60	5	M12*25

- S08-AM35-20□-F4

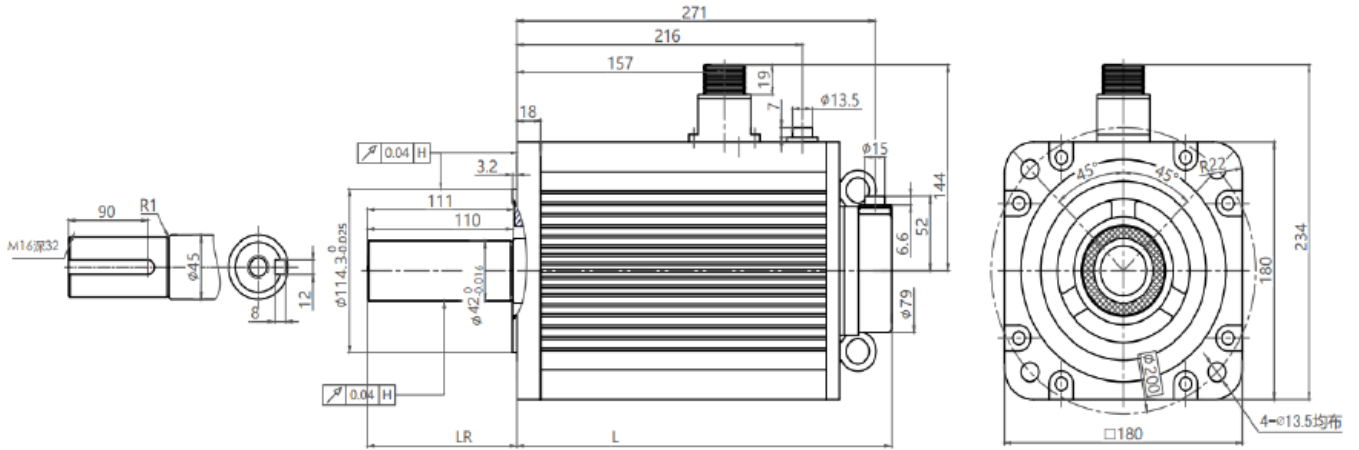

Torque-Motor Speed Characteristics

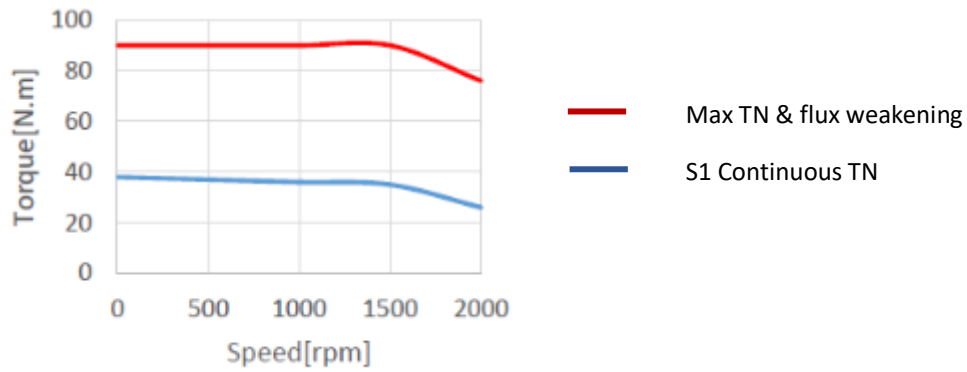

Model	Frame Size	Name	Power (KW)	Motor Length (mm)	Shaft Diameter (mm)	Shaft End Spec. (mm)			
						Keyway Width	Keyway Length	Keyway Depth	Screw Thread
S08-AM35-20□-F4	180	AM35	5.5	217.5	42	12	90	8	M16*32
S08-AM35-20B□-F4				280.5		12	90	8	M16*32

• S08-AM35-20□-F5

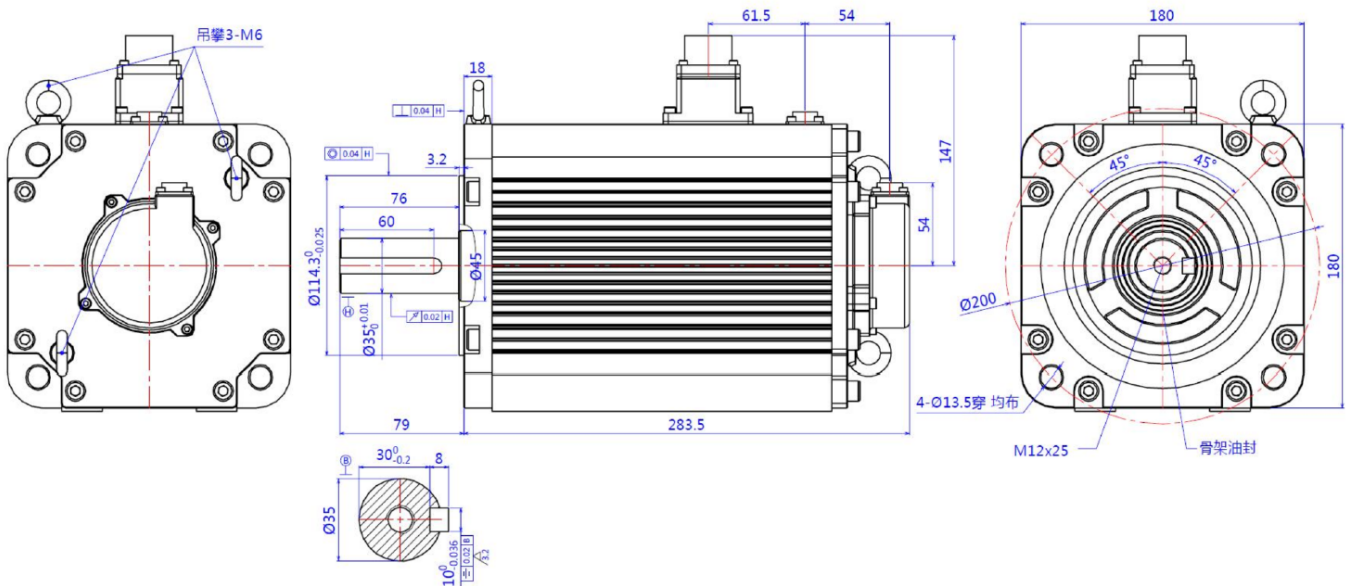

Torque-Motor Speed Characteristics

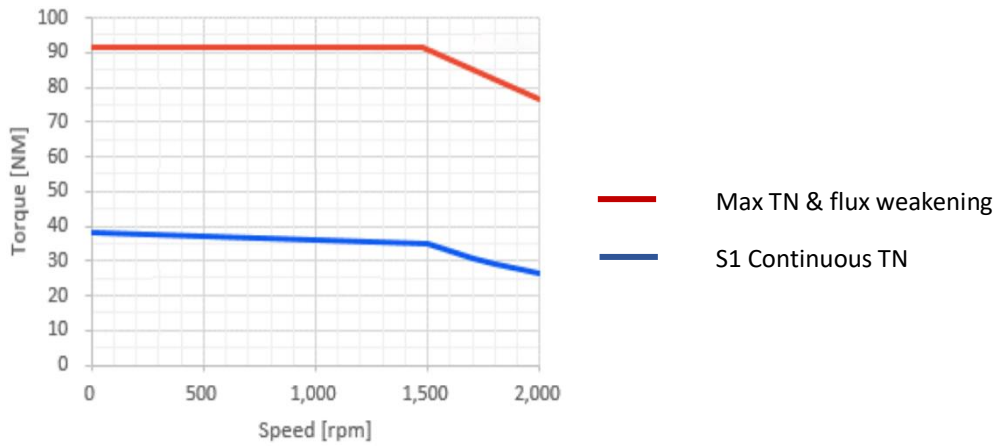

Model	Frame Size	Name	Power (KW)	Motor Length (mm)	Shaft Diameter (mm)	Shaft End Spec.(mm)			
						Keyway Width	Keyway Length	Keyway Depth	Screw Thread
S08-AM35-20□-F5	180	AM35	5.5	220.5	35	10	60	5	M12*25
S08-AM35-20B□-F5				283.5		10	60	5	M12*25

S08-AM48-20□-F5

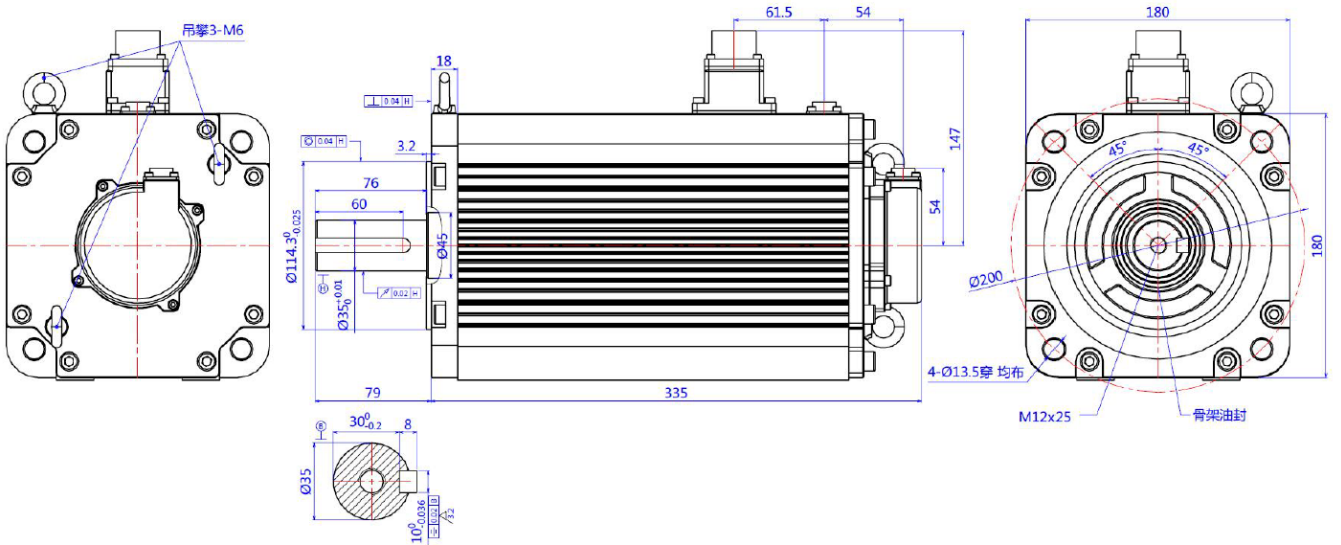

Torque-Motor Speed Characteristics

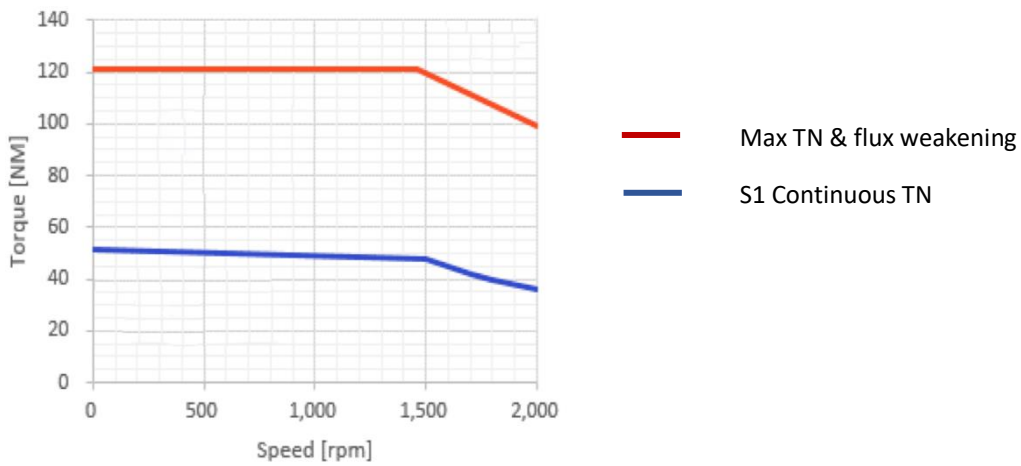

Model	Frame Size	Name	Power (KW)	Motor Length (mm)	Shaft Diameter (mm)	Shaft End Spec.(mm)			
						Keyway Width	Keyway Length	Keyway Depth	Screw Thread
S08-AM48-20□-F5	180	AM48	7.5	272	35	10	60	5	M12*25
S08-AM48-20B□-F5				335		10	60	5	M12*25

● S08-AM8-50K-F1

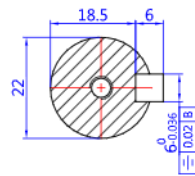
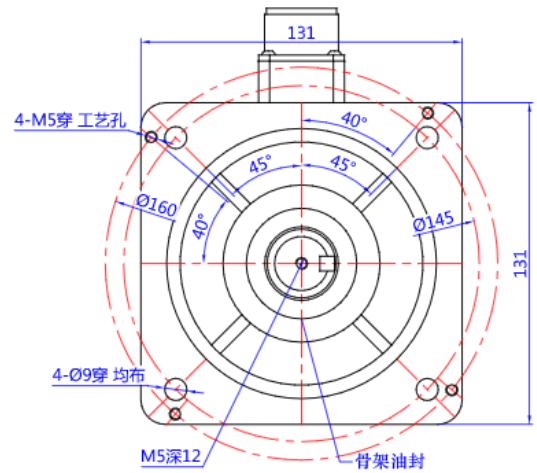
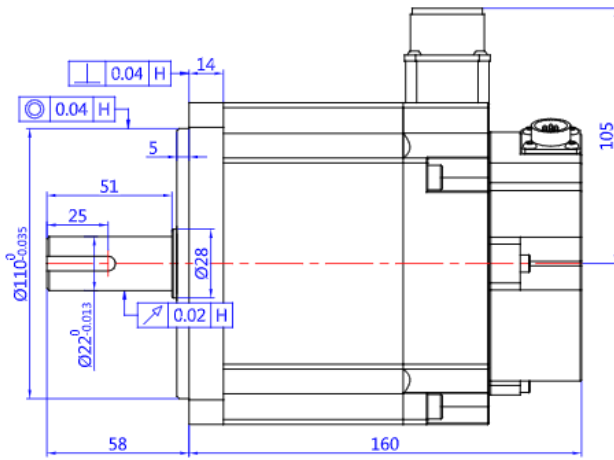

技术要求:
 1 电机规格: STD13A
 2 尾部带新代mini磁编码器

Torque-Motor Speed Characteristics

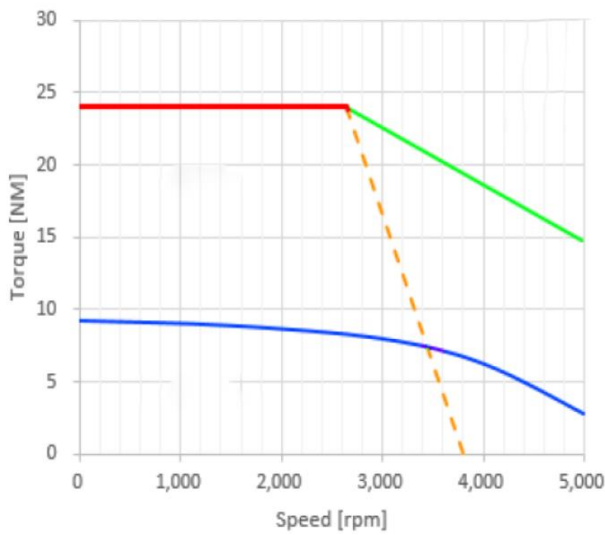

- Max TN & flux weakening
- S1 Continuous TN
- Weakening
- - - U limited 380V

Model	Frame Size	Name	Power (KW)	Motor Length (mm)	Shaft Diameter (mm)	Shaft End Spec.(mm)			
						Keyway Width	Keyway Length	Keyway Depth	Screw Thread
S08-AM8-50K-F1	130	AM8	1.7	160	22	6	25	6	M5*12

• S08-AM11-50K-F1

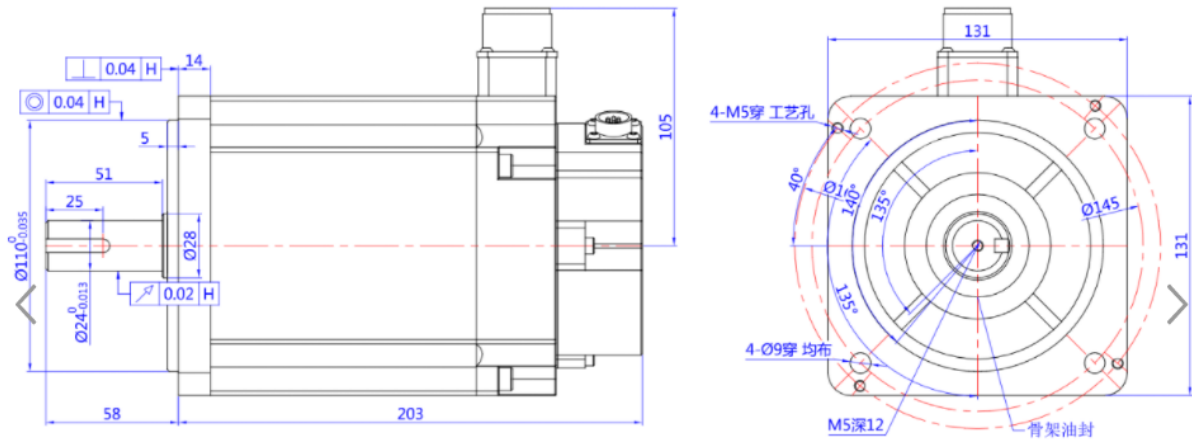

Torque-Motor Speed Characteristics

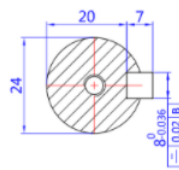
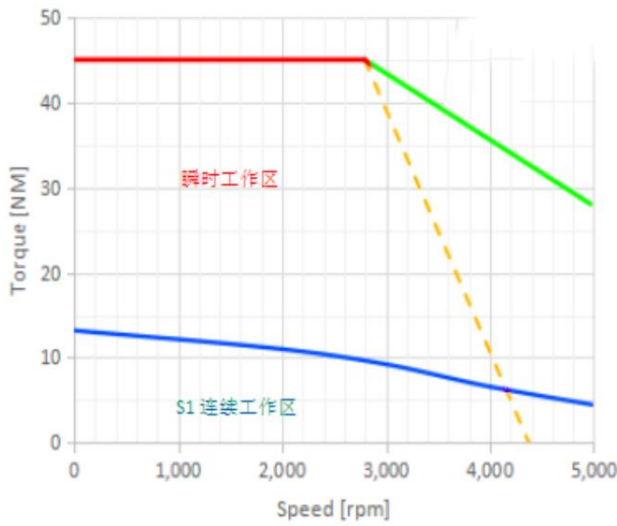

技术要求:
 1 电机规格: STD13B
 2 尾部带新一代mini磁编码器

- Max TN & flux weakening
- S1 Continuous TN
- Weakening
- - - U limited 380V

Model	Frame Size	Name	Power (KW)	Motor Length (mm)	Shaft Diameter (mm)	Shaft End Spec.(mm)			
						Keyway Width	Keyway Length	Keyway Depth	Screw Thread
S08-AM8-50K-F1	130	AM11	2.3	203	24	8	25	4	M5*12

Z Series

- S08-AM03-50□-Z3

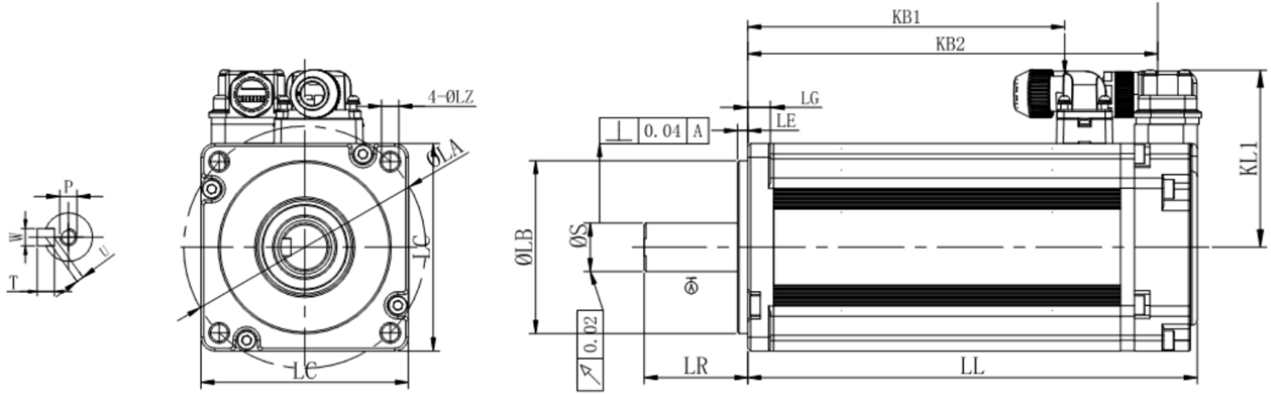

Torque-Motor Speed Characteristics

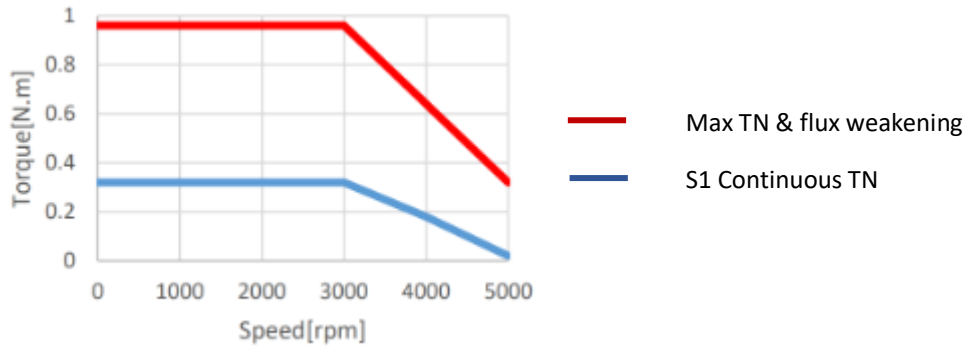

Model	Frame Size	Name	Power (KW)	Motor Length (mm)	Shaft Diameter (mm)	Shaft End Spec.(mm)			
						Keyway Width	Keyway Length	Keyway Depth	Screw Thread
S08-AM03-50□-Z3	40	AM03	0.1	98.1	8	3	14	3	M3*6
S08-AM03-50B□-Z3				3		14	3	M3*6	
				3		14	3	M3*6	
							137.2		

- S08 - AM06 - 50□ - Z3

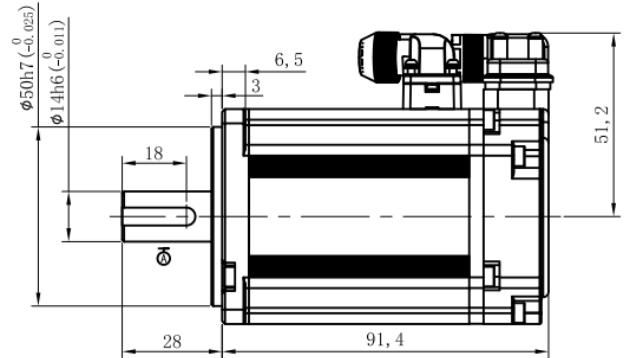
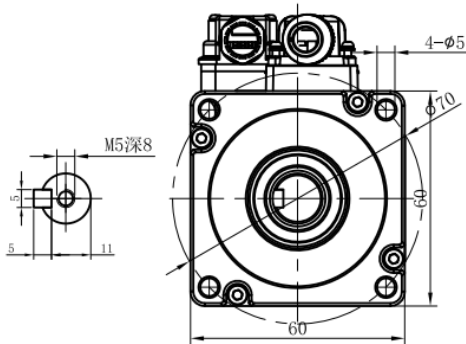

Torque-Motor Speed Characteristics

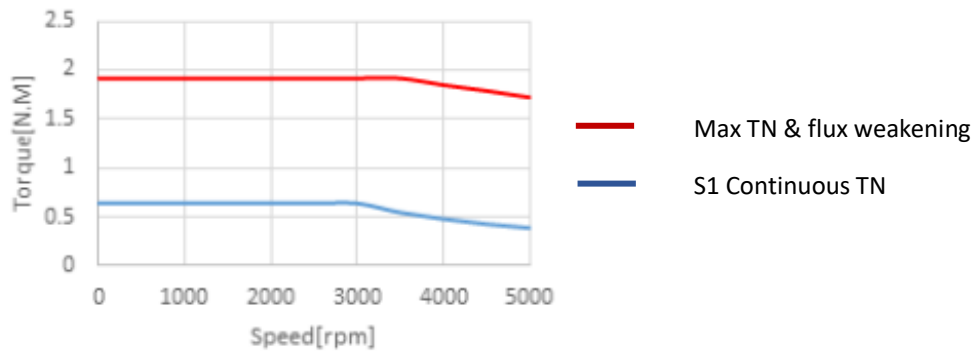

Model	Frame Size	Name	Power (KW)	Motor Length (mm)	Shaft Diameter (mm)	Shaft End Spec.(mm)			
						Keyway Width	Keyway Length	Screw Thread	Keyway Depth
S08-AM06-50□-Z3	60	AM06	0.2	91.4	14	5	18	M5*8	5
S08-AM06-50B□-Z3				132		5	18	M5*8	5

- S08 – AM1 - 60□ – Z4

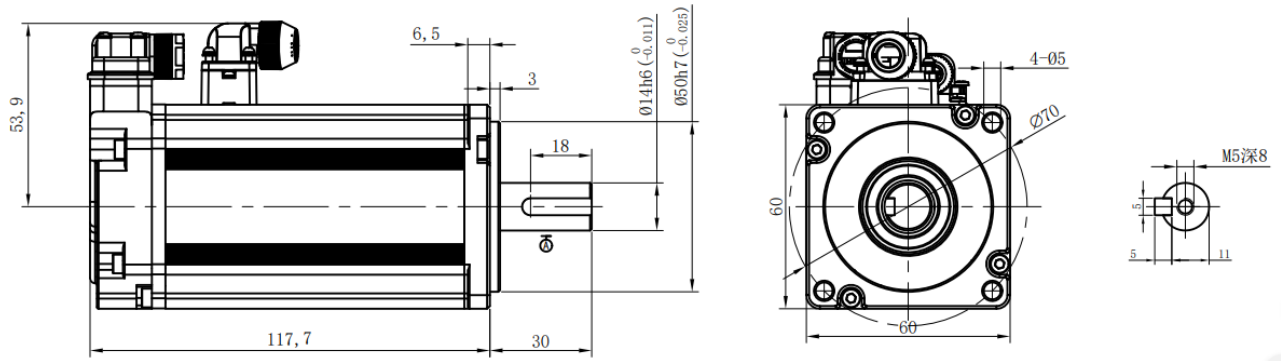

Torque-Motor Speed Characteristics

电源电压 (AC:220V)

转矩 (N·m) 虚线为参考线

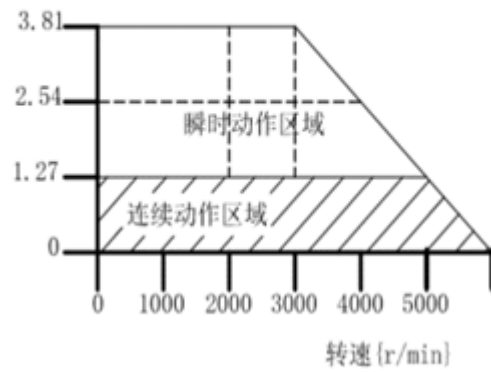

— Max TN & flux weakening
— S1 Continuous TN

Model	Frame Size	Name	Power (KW)	Motor Length (mm)	Shaft Diameter (mm)	Shaft End Spec.(mm)			
						Keyway Width	Keyway Length	Keyway Depth	Screw Thread
S08-AM1-60□-Z4	60	AM1	0.4	117.7	14	5	18	3	M5*8
S08-AM1-60B□-Z4				153		5	18	3	M5*8

• S08 – AM1 - 50□ – Z3

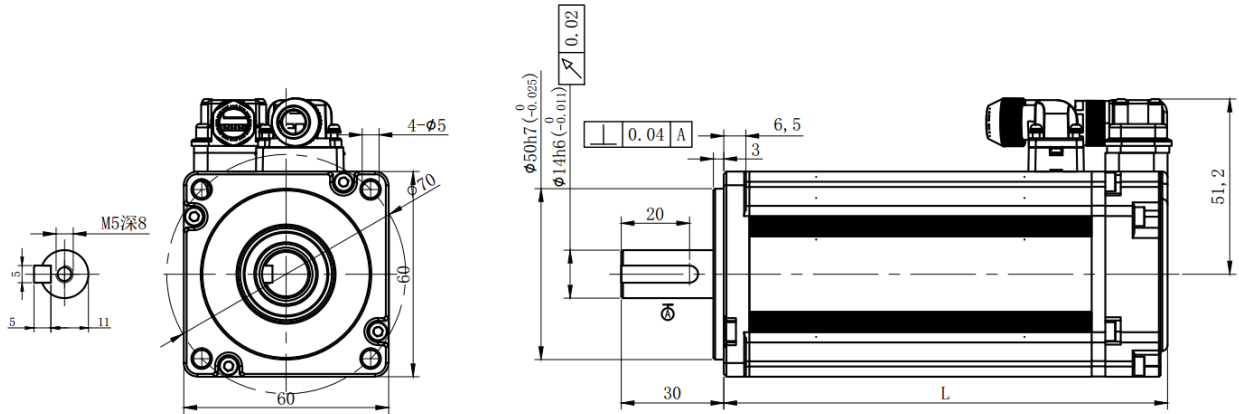

Torque-Motor Speed Characteristics

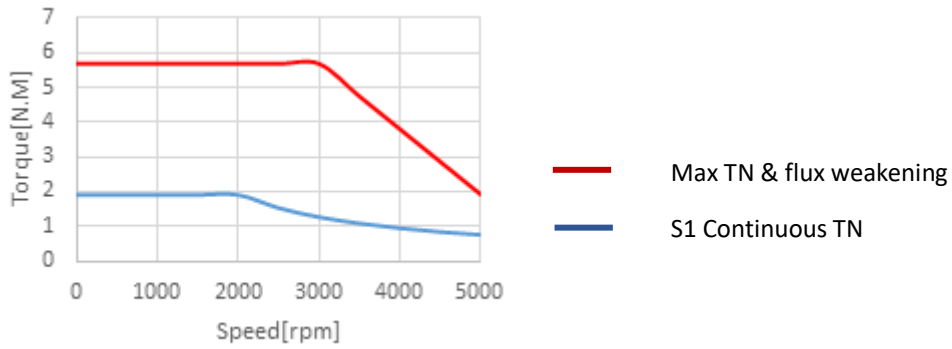

Model	Frame Size	Name	Power (KW)	Motor Length (mm)	Shaft Diameter (mm)	Shaft End Spec.(mm)			
						Keyway Width	Keyway Length	Screw Thread	Keyway Depth
S08-AM1-50□-Z3	60	AM1	0.4	130	14	5	20	M5*8	4
S08-AM1-50B□-Z3				5		20	M5*8	4	

- S08-AM2-60□-Z4

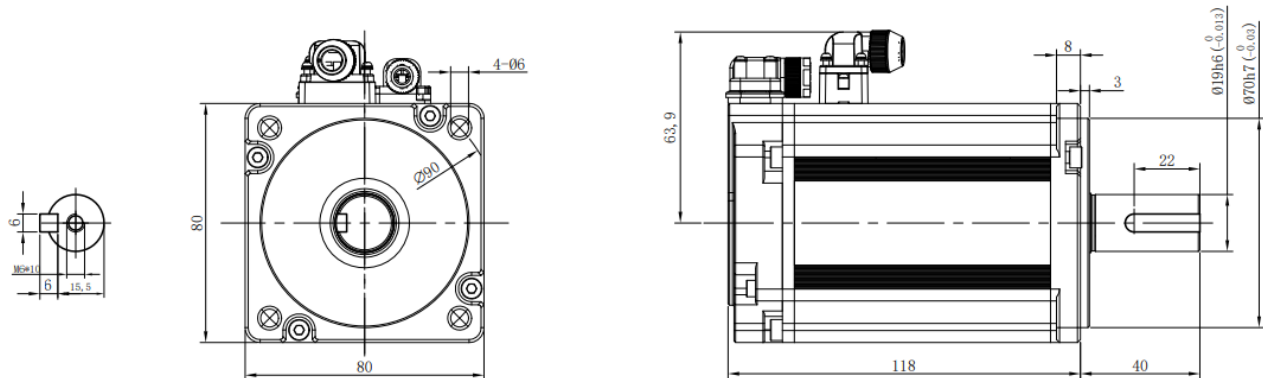

Torque-Motor Speed Characteristics

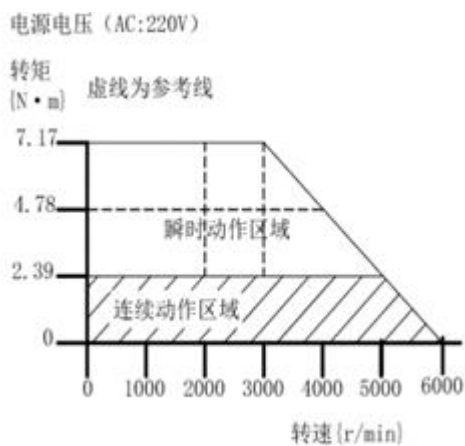

Model	Frame Size	Name	Power (KW)	Motor Length (mm)	Shaft Diameter (mm)	Shaft End Spec.(mm)			
						Keyway Width	Keyway Depth	Keyway Length	Screw Thread
S08-AM2-60□-Z4	80	AM2	0.75	118	19	6	3.5	22	M6*10
S08-AM2-60B□-Z4				159		6	3.5	22	M6*10

- S08 – AM3 - 50□ – Z3

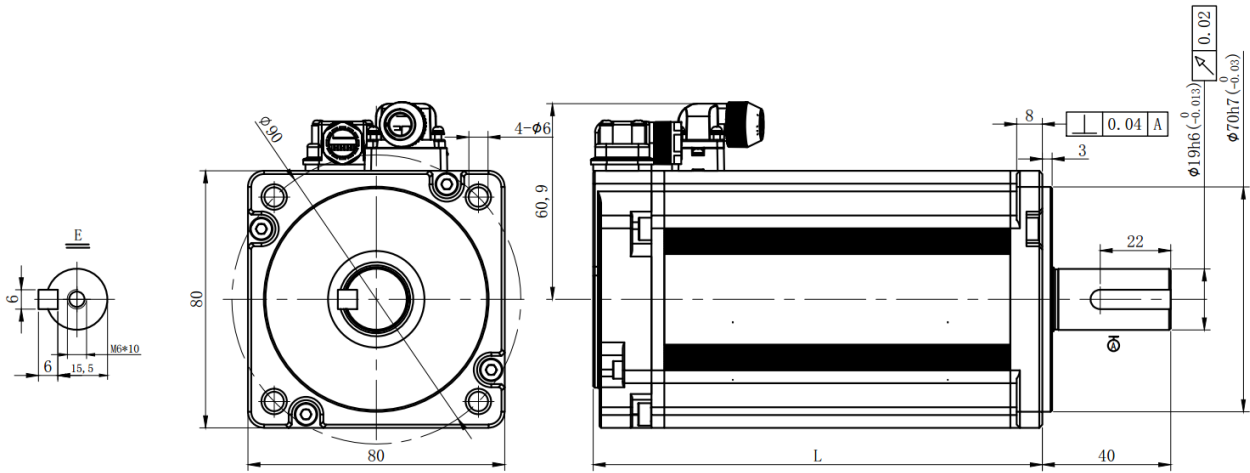

Torque-Motor Speed Characteristics

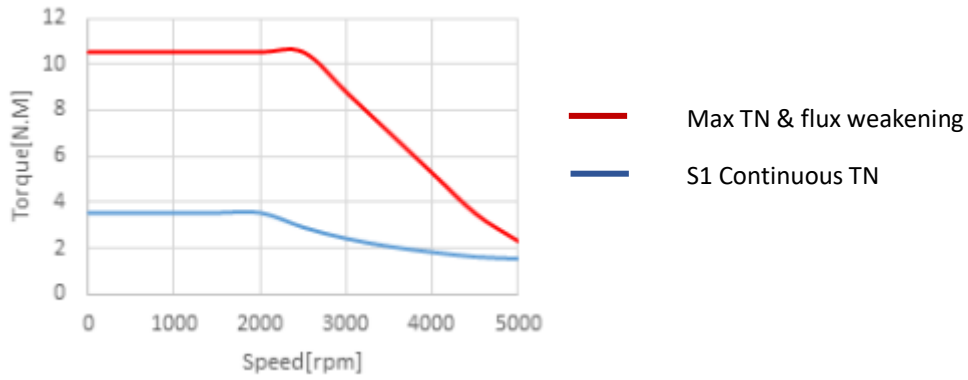

Model	Frame Size	Name	Power (KW)	Motor Length (mm)	Shaft Diameter (mm)	Shaft End Spec.(mm)			
						Keyway Width	Keyway Length	Keyway Depth	Screw Thread
S08-AM3-50□-Z3	80	AM3	1.0	140	19	6	22	3.5	M6*10
S08-AM3-50B□-Z3				181		6	22	3.5	M6*10

H Series

- S08-AM03-50□-H1

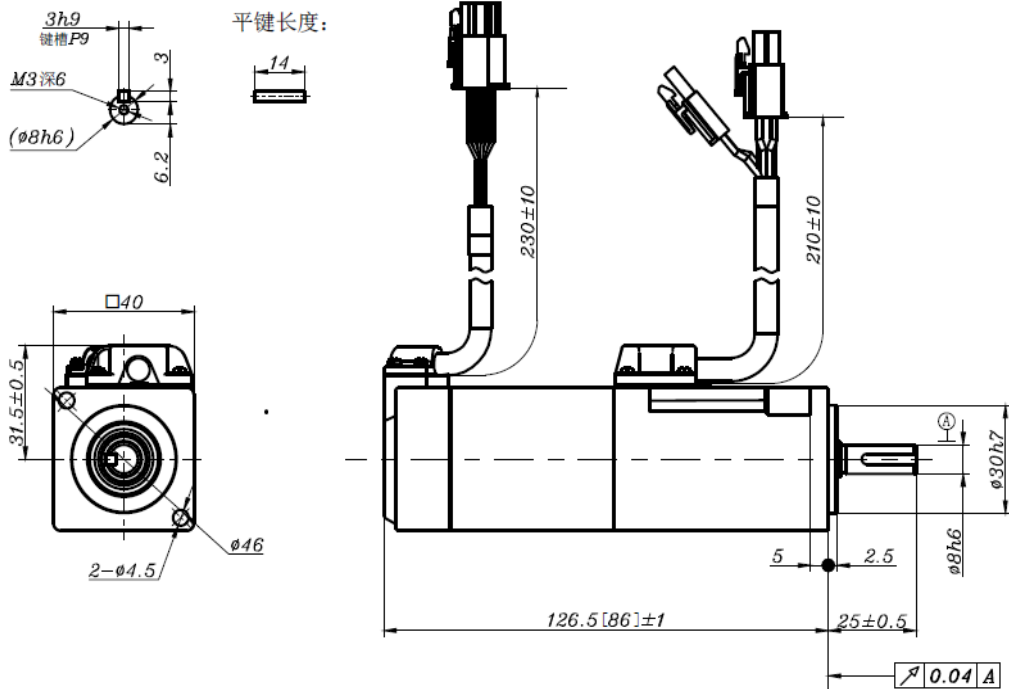

Torque-Motor Speed Characteristics

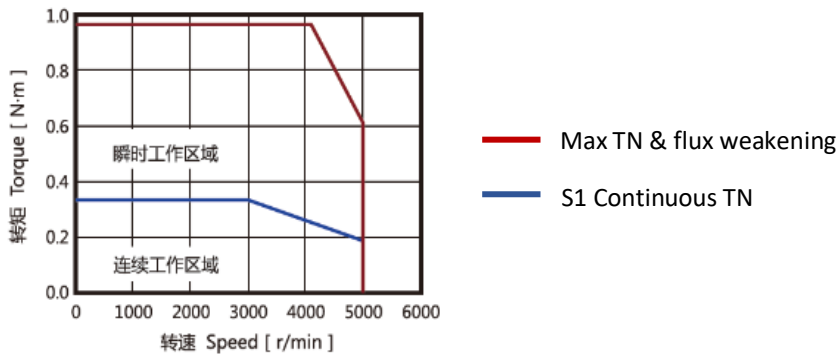

Model	Frame Size	Name	Power (KW)	Motor Length (mm)	Shaft Diameter (mm)	Shaft End Spec.(mm)			
						Keyway Width	Keyway Length	Keyway Depth	Screw Thread
S08-AM03-50□-H1	40	AM03	0.1	86	8	3	14	3	M3*6
S08-AM03-50B□-H1				126.5		3	14	3	M3*6
						3	14	3	M3*6
						3	14	3	M3*6

• S08 - AM03 - 50□ - H3

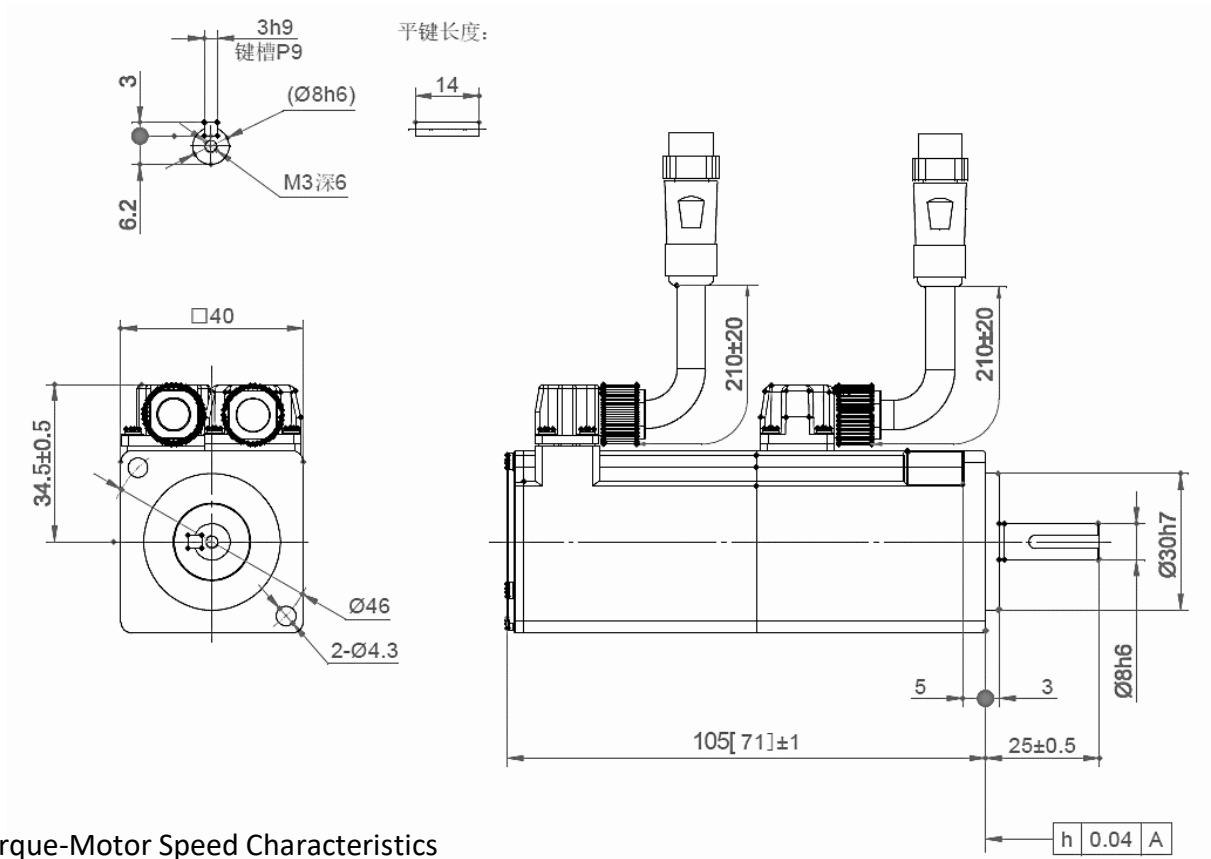

Torque-Motor Speed Characteristics

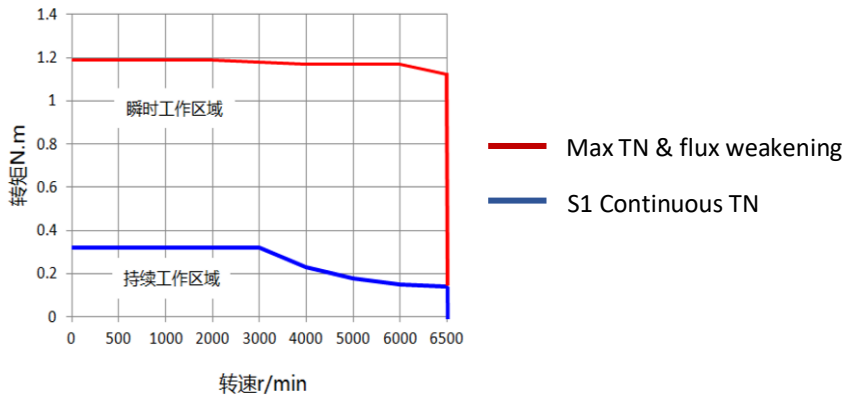

Model	Frame Size	Name	Power (KW)	Motor Length (mm)	Shaft Diameter (mm)	Shaft End Spec.(mm)			
						Keyway Width	Keyway Length	Keyway Depth	Screw Thread
S08-AM03-50□-H3	40	AM03	0.1	71	8	3	14	1.8	M3*6
S08-AM03-50B□-H3				105		3	14	1.8	M3*6

• S08 - AM06 - 50□ - H1

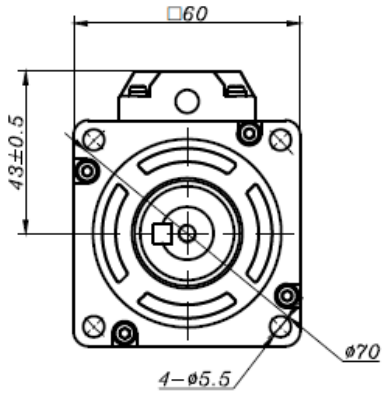
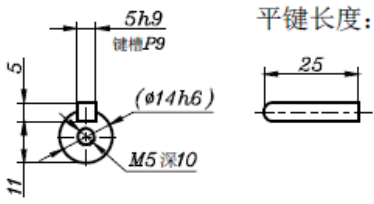

Torque-Motor Speed Characteristics

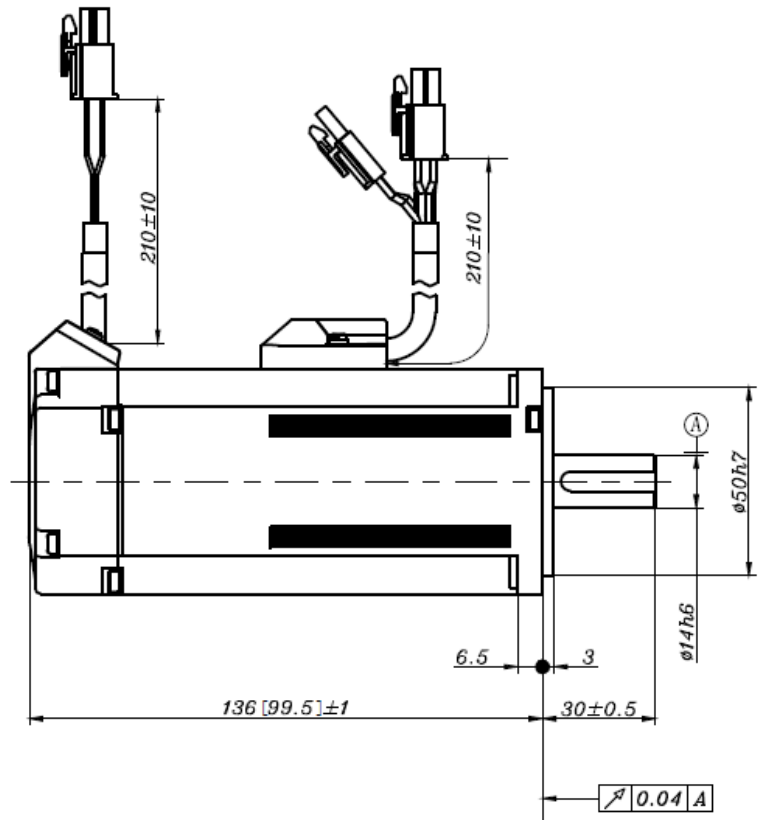
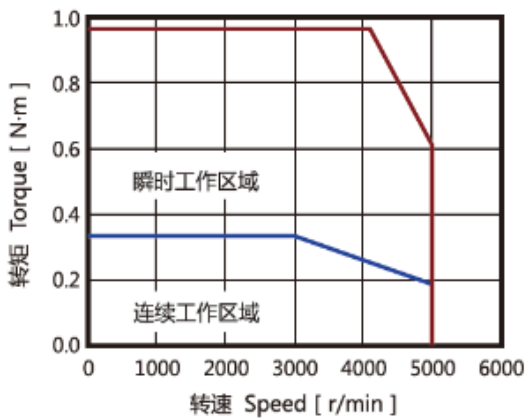

— Max TN & flux weakening
 — S1 Continuous TN

Model	Frame Size	Name	Power (KW)	Motor Length (mm)	Shaft Diameter (mm)	Shaft End Spec.(mm)			
						Keyway Width	Keyway Length	Keyway Depth	Screw Thread
S08-AM06-50□-H1	60	AM06	0.2	99.5	14	5	25	5	M5*10
S08-AM06-50B□-H1				136		5	25	5	M5*10

● S08 – AM06-50□-H3

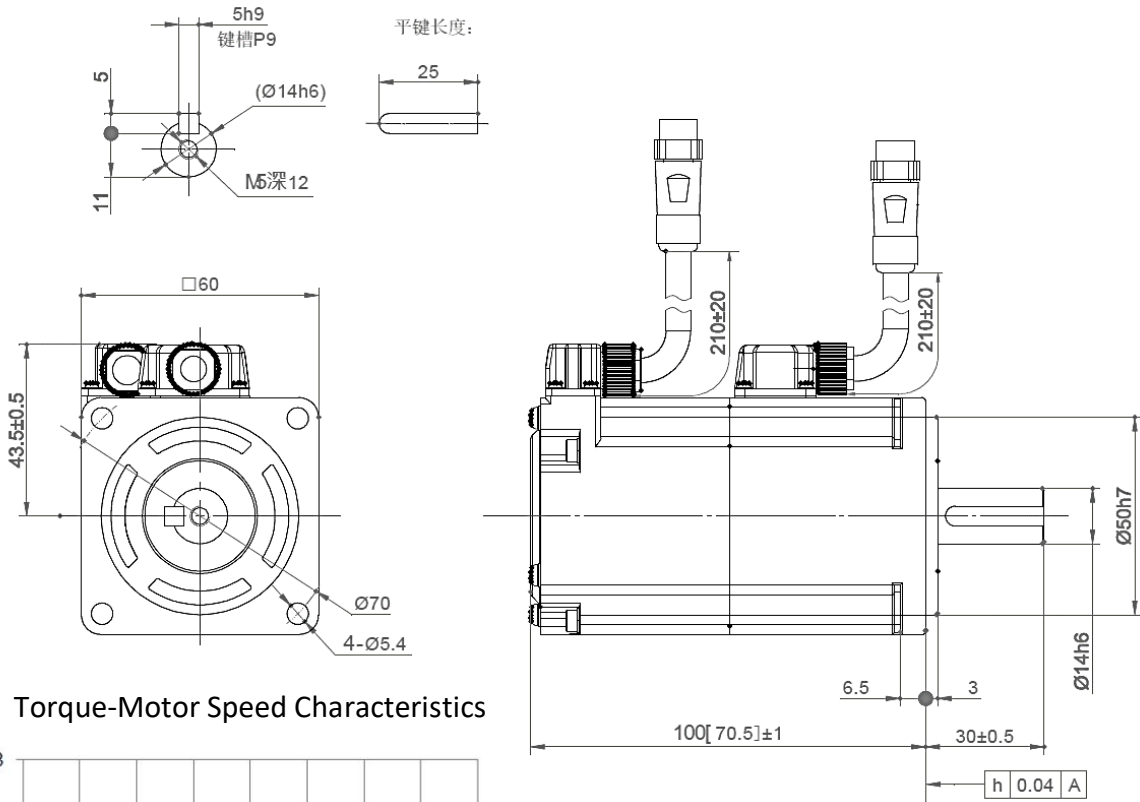

Torque-Motor Speed Characteristics

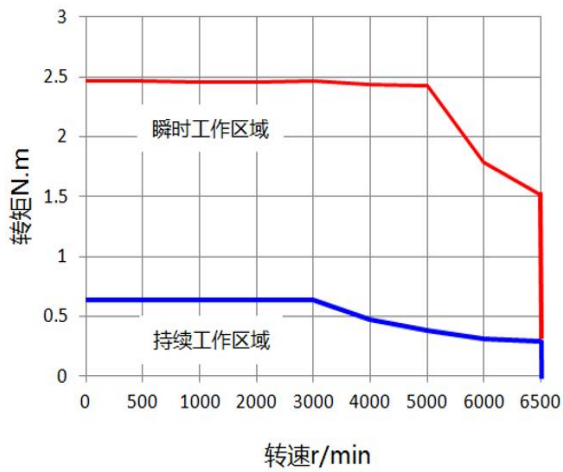

Model	Frame Size	Name	Power (KW)	Motor Length (mm)	Shaft Diameter (mm)	Shaft End Spec.(mm)			
						Keyway Width	Keyway Length	Keyway Depth	Screw Thread
S08-AM06-50□-H3	60	AM06	0.2	70.5	14	5	25	3	M5*12
S08-AM06-50B□-H3				100		5	25	3	M5*12

• S08 – AM1-50□-H1

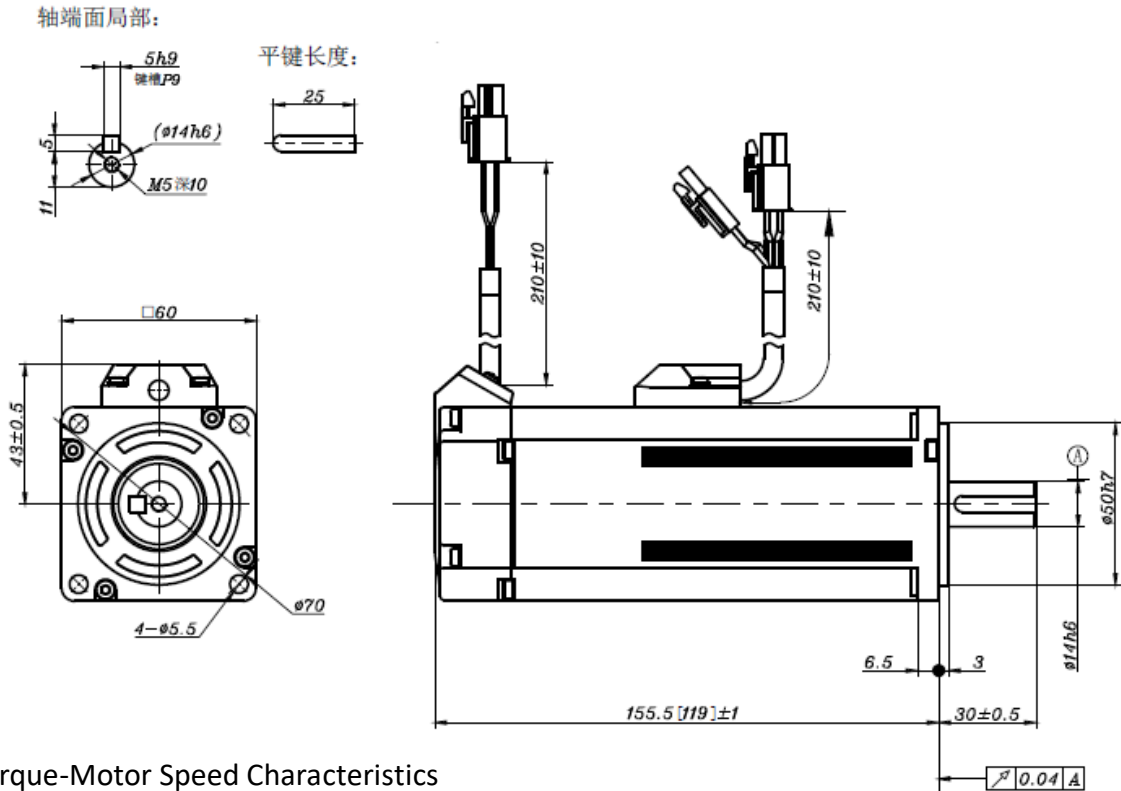

Torque-Motor Speed Characteristics

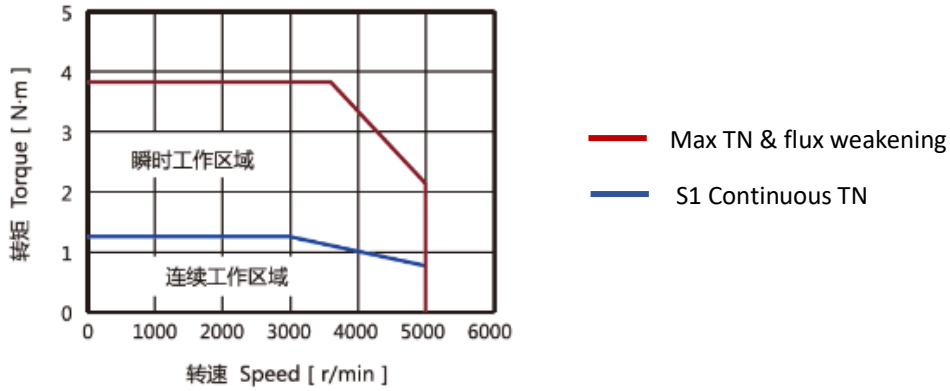

Model	Frame Size	Name	Power (KW)	Motor Length (mm)	Shaft Diameter (mm)	Shaft End Spec.(mm)			
						Keyway Width	Keyway Length	Keyway Depth	Screw Thread
S08-AM1-50□-H1	60	AM1	0.4	119	14	5	25	5	M5*10
S08-AM1-50B□-H1				5		25	5	M5*10	

• S08 – AM1-50□-H2

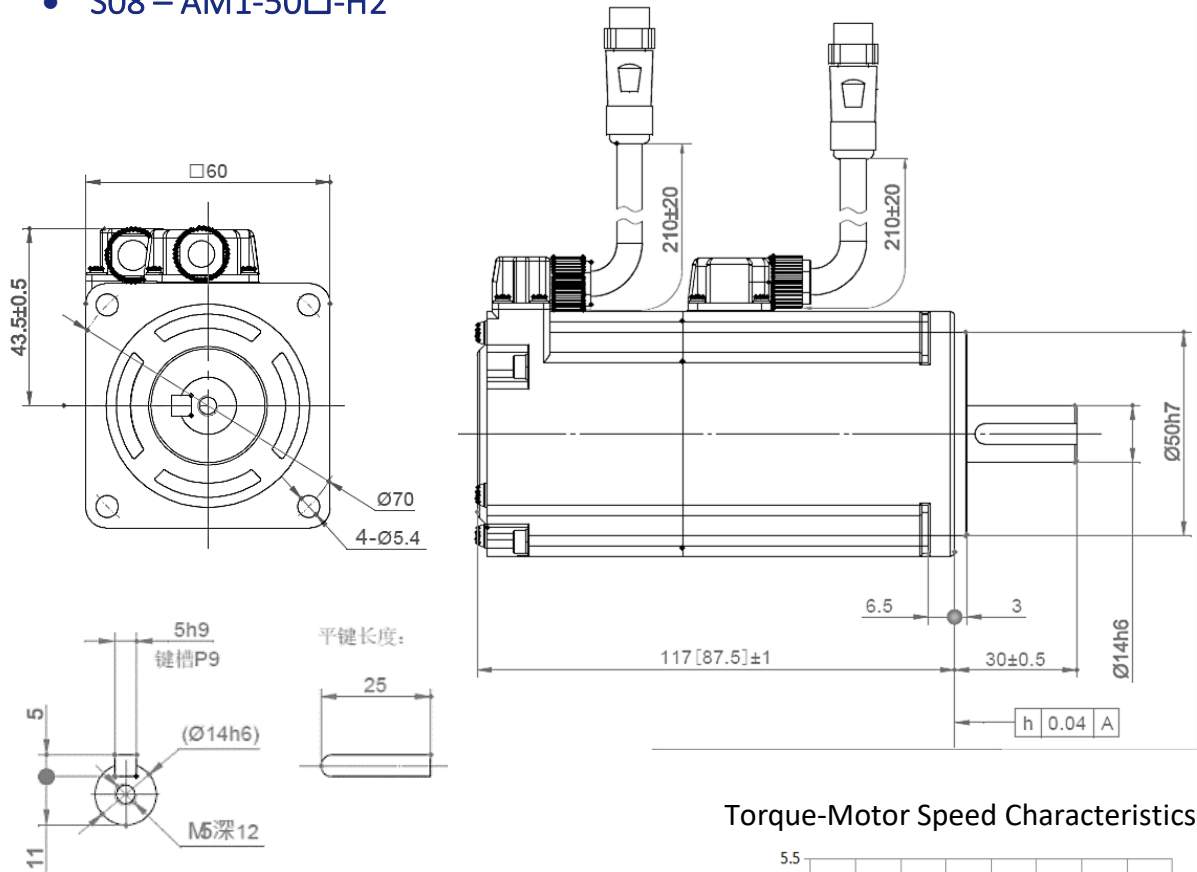

Torque-Motor Speed Characteristics

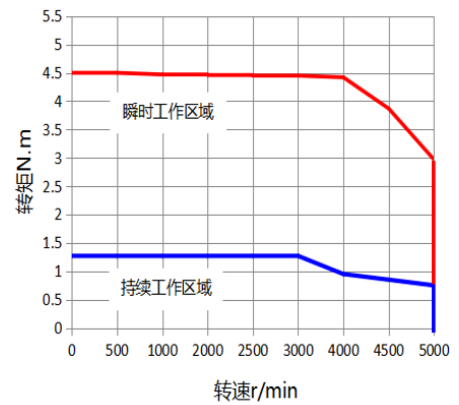

— Max TN & flux weakening
 — S1 Continuous TN

Model	Frame Size	Name	Power (KW)	Motor Length (mm)	Shaft Diameter (mm)	Shaft End Spec.(mm)			
						Keyway Width	Keyway Length	Keyway Depth	Screw Thread
S08-AM1-50□-H2	60	AM1	0.4	87.6	14	5	25	3	M5*12
S08-AM1-50B□-H2				5		25	3	M5*12	

• S08 – AM1-50□-H3

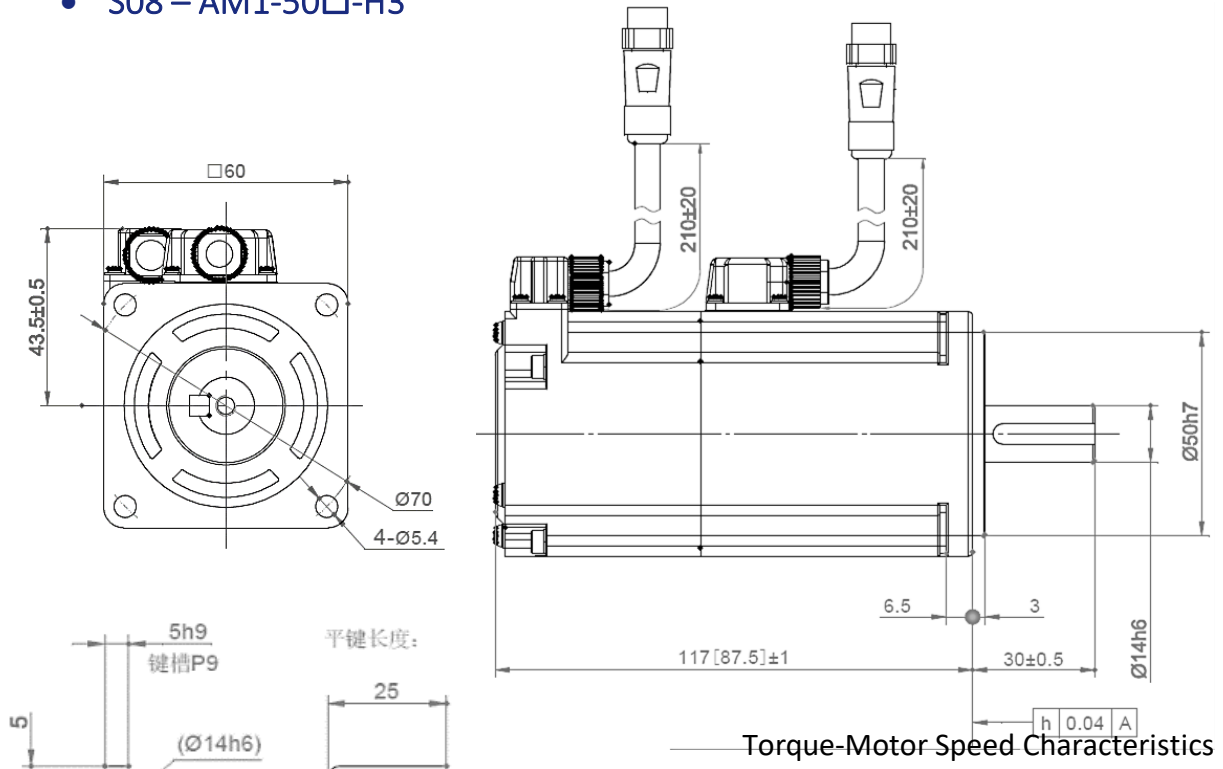

Torque-Motor Speed Characteristics

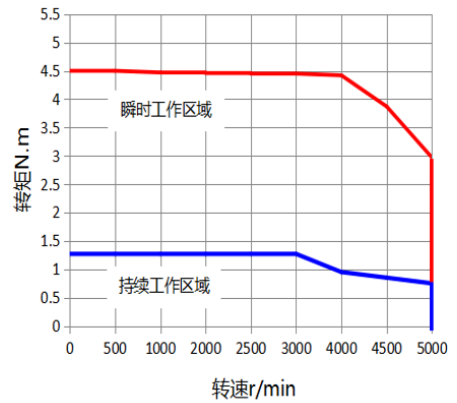

— Max TN & flux weakening
 — S1 Continuous TN

Model	Frame Size	Name	Power (KW)	Motor Length (mm)	Shaft Diameter (mm)	Shaft End Spec. (mm)			
						Keyway Width	Keyway Length	Keyway Depth	Screw Thread
S08-AM1-50□-H3	60	AM1	0.4	87.6	14	5	25	3	M5*12
S08-AM1-50B□-H3				177		5	25	3	M5*12

• S08 – AM2-50□-H1

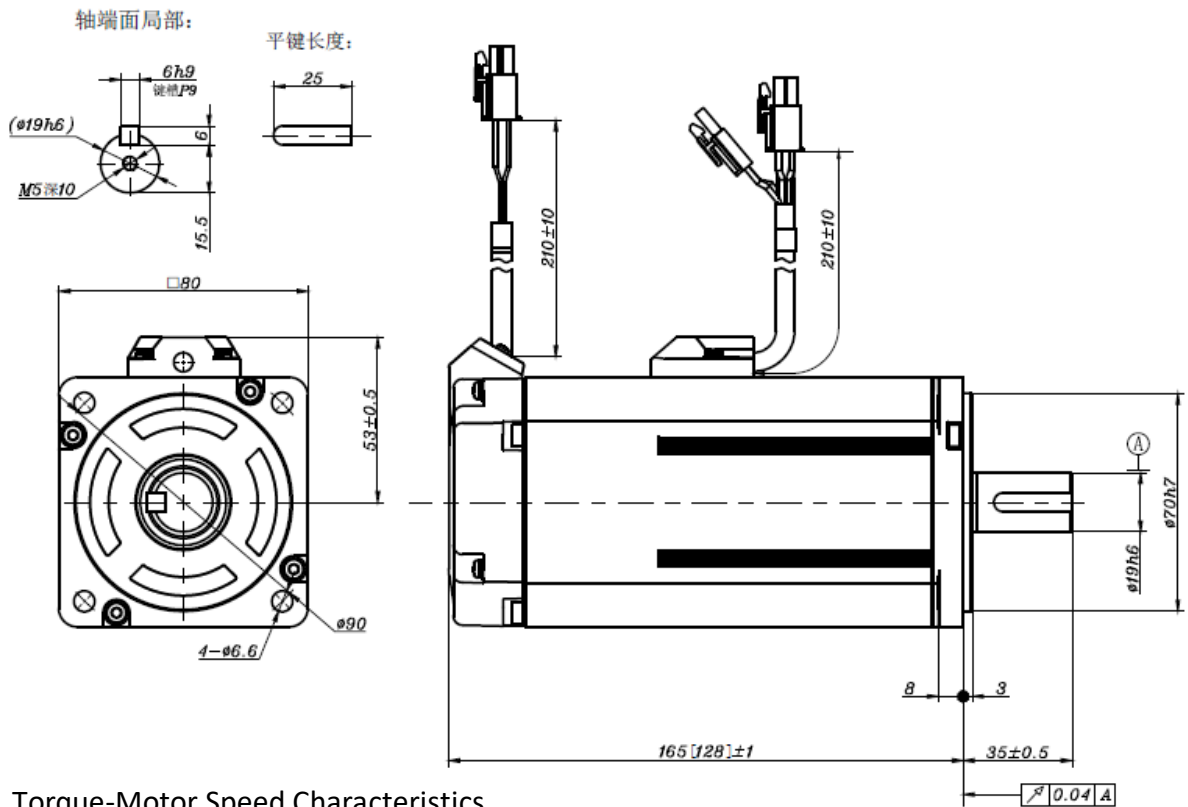

Torque-Motor Speed Characteristics

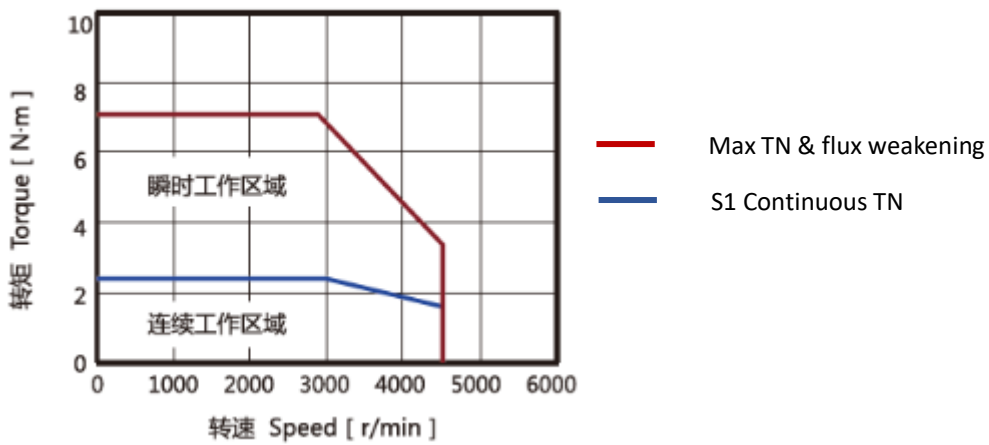

Model	Frame Size	Name	Power (KW)	Motor Length (mm)	Shaft Diameter (mm)	Shaft End Spec.(mm)			
						Keyway Width	Keyway Depth	Keyway Length	Screw Thread
S08-AM2-50□-H1	60	AM2	0.75	128	19	6	6	25	M5*10
S08-AM2-50B□-H1				165		6	6	25	M5*10

● S08 – AM2-50□-H2

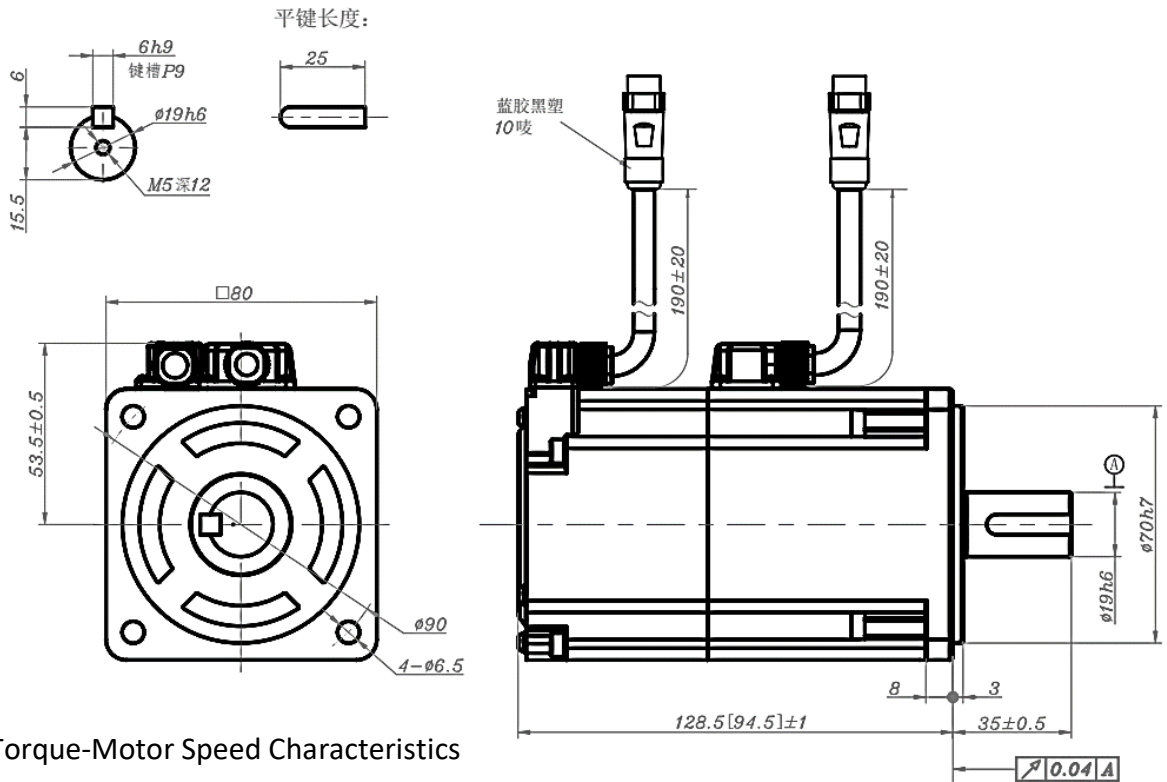

Torque-Motor Speed Characteristics

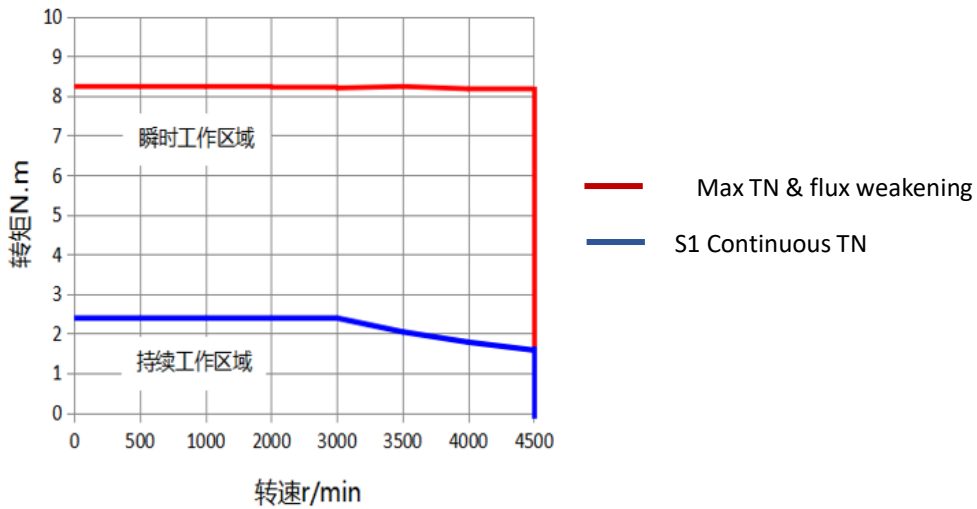

Model	Frame Size	Name	Power (KW)	Motor Length (mm)	Shaft Diameter (mm)	Shaft End Spec.(mm)			
						Keyway Width	Keyway Length	Keyway Depth	Screw Thread
S08-AM2-50□-H2	80	AM2	0.75	94.5	19	6	25	2.5	M6*12
S08-AM2-50B□-H2				6		25	2.5	M6*12	

● S08 – AM2-50□-H3

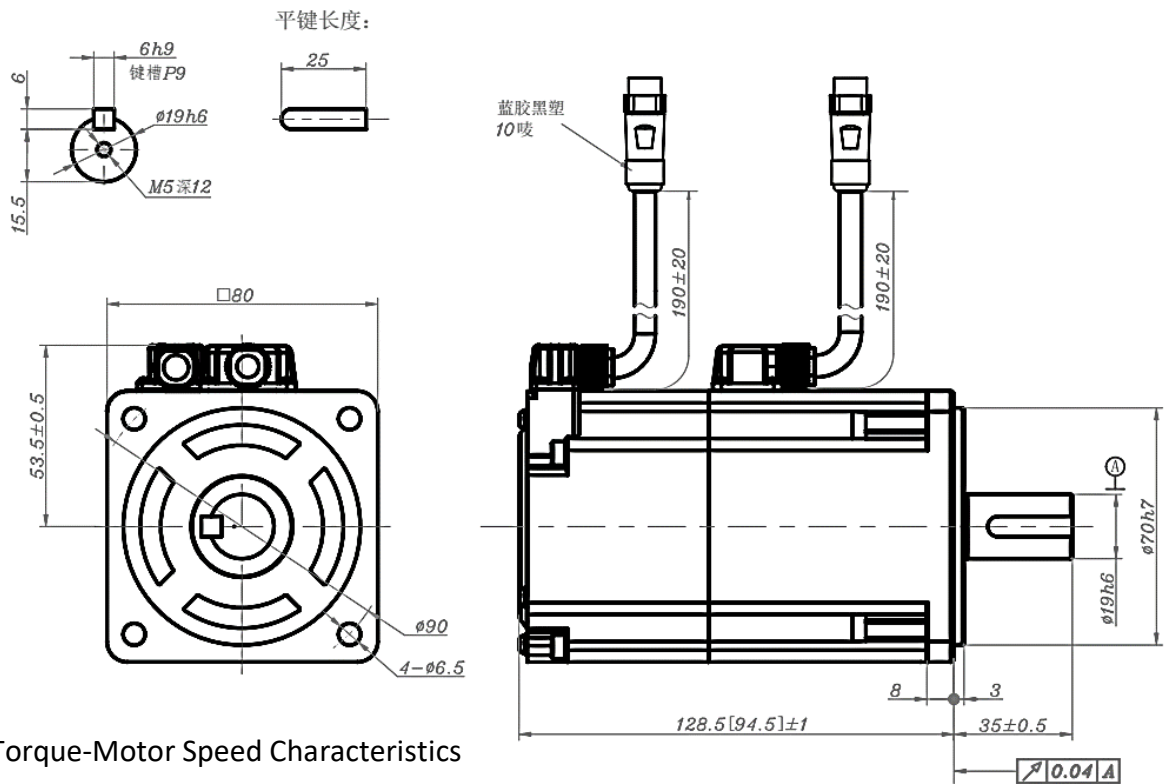

Torque-Motor Speed Characteristics

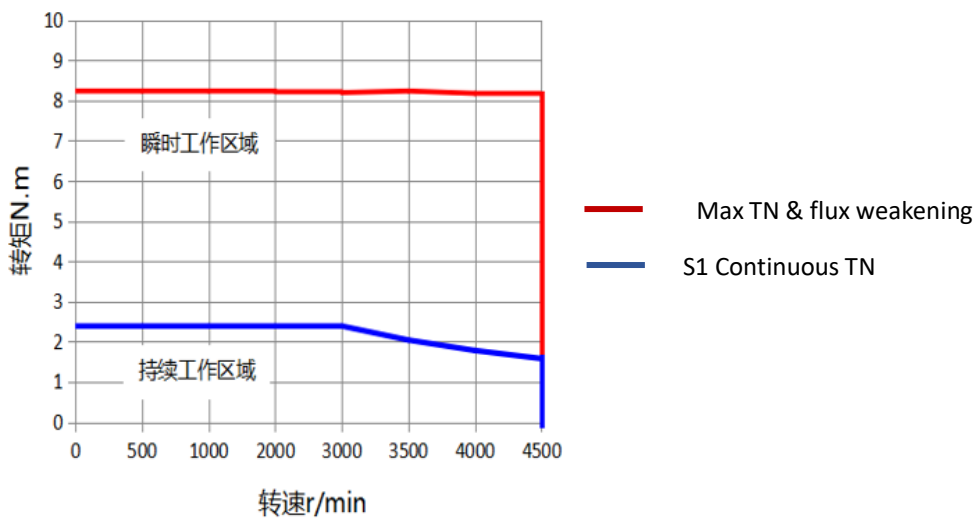

Model	Frame Size	Name	Power (KW)	Motor Length (mm)	Shaft Diameter (mm)	Shaft End Spec.(mm)			
						Keyway Width	Keyway Length	Keyway Depth	Screw Thread
S08-AM2-50□-H3	80	AM2	0.75	94.5	19	6	25	2.5	M6*12
S08-AM2-50B□-H3				128.5		6	25	2.5	M6*12

• S08 – AM4-40□-H2

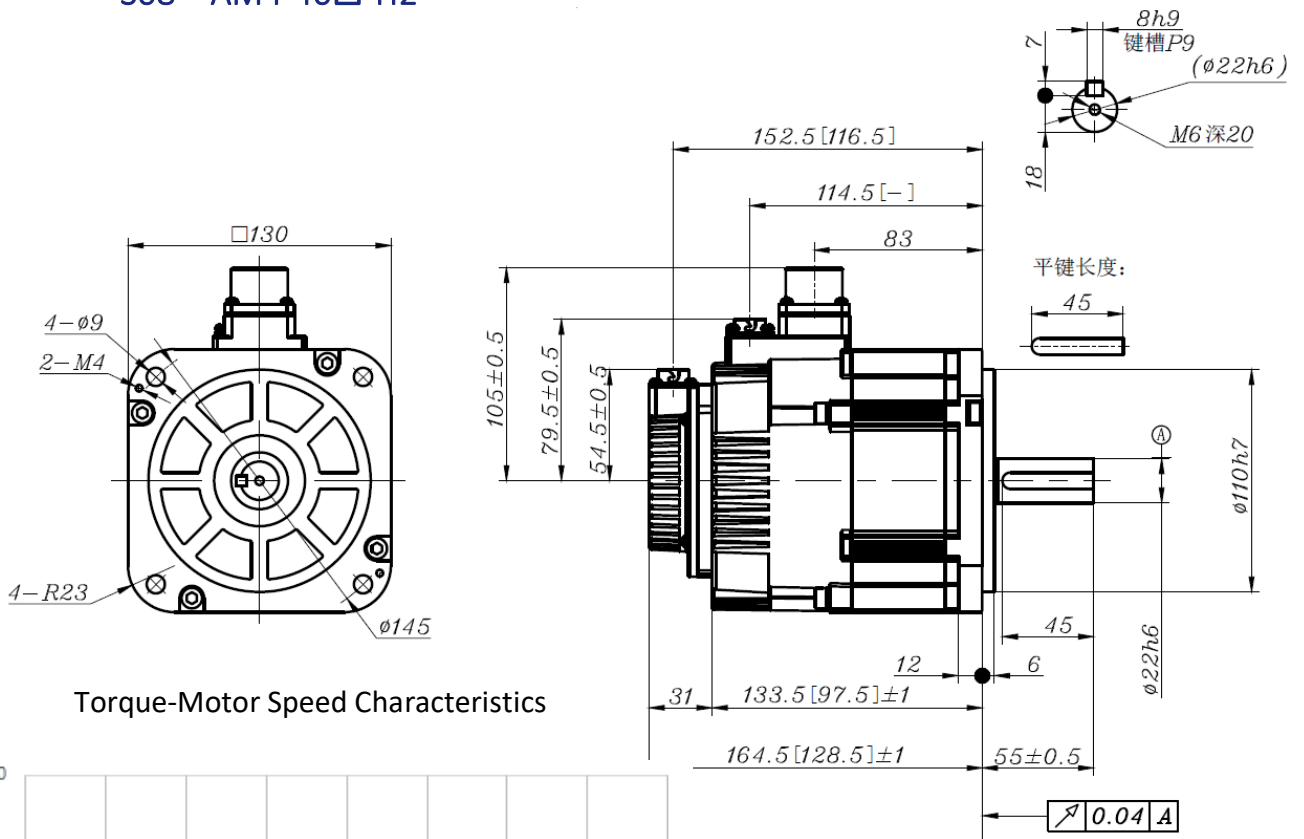

Torque-Motor Speed Characteristics

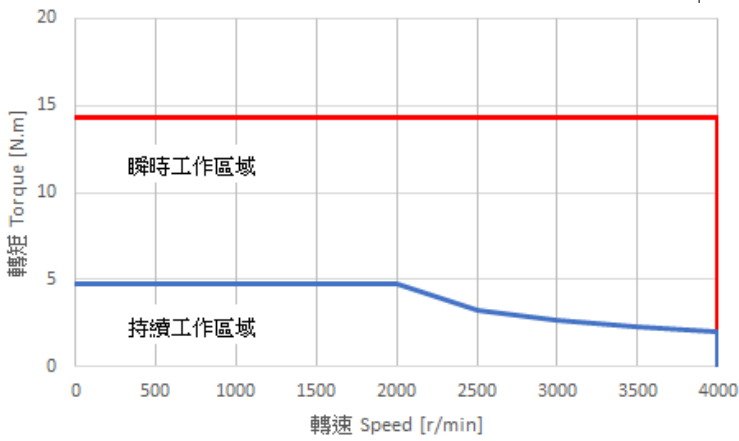

— Max TN & flux weakening
 — S1 Continuous TN

Model	Frame Size	Name	Power (KW)	Motor Length (mm)	Shaft Diameter (mm)	Shaft End Spec.(mm)			
						Keyway Width	Keyway Length	Keyway Depth	Screw Thread
S08-AM4-40□-H2	130	AM4	1	128.5	22	8	45	4	M6*20
S08-AM4-40B□-H2				164.5		8	45	4	M6*20

• S08 – AM5-40□-H1

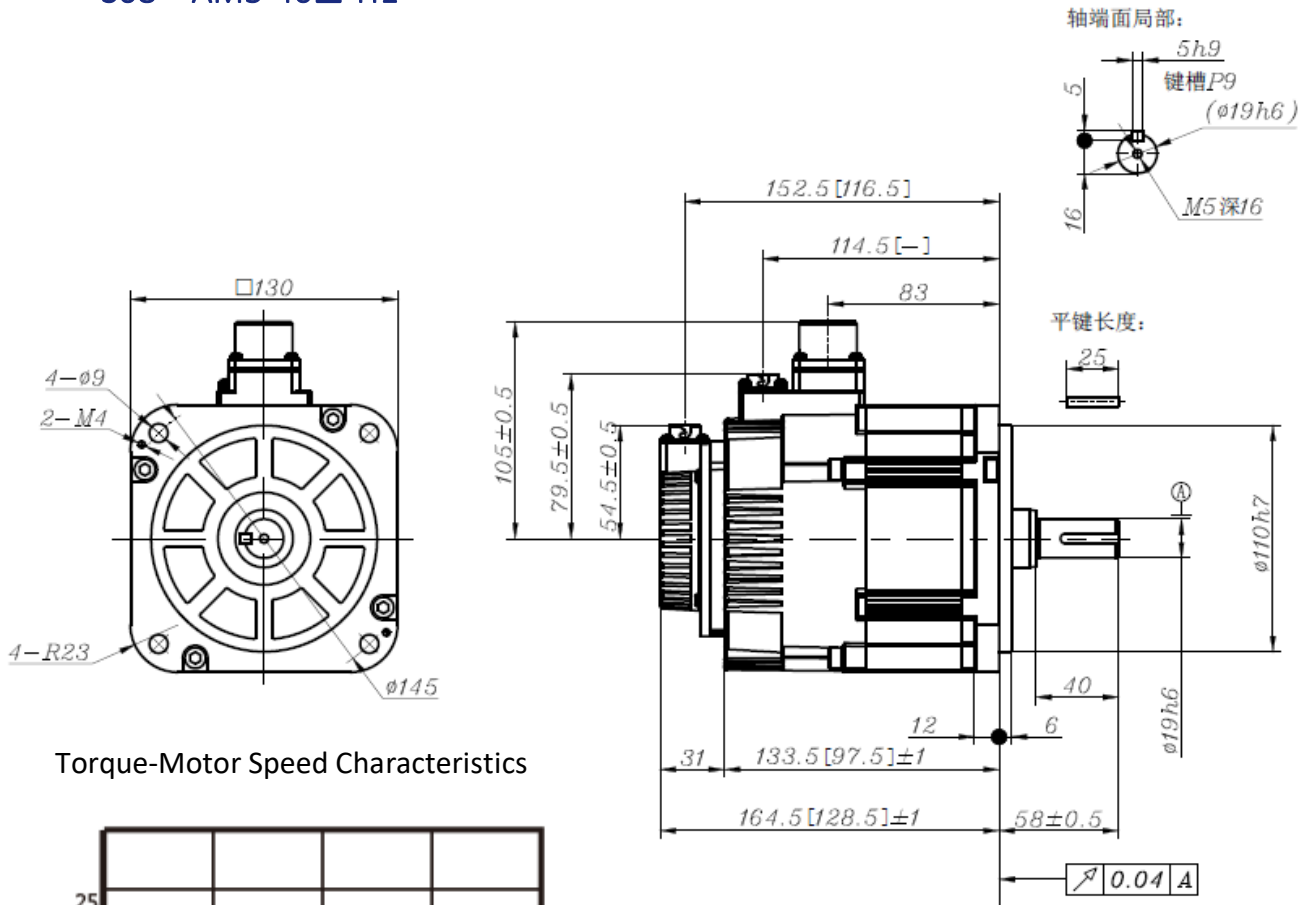

Torque-Motor Speed Characteristics

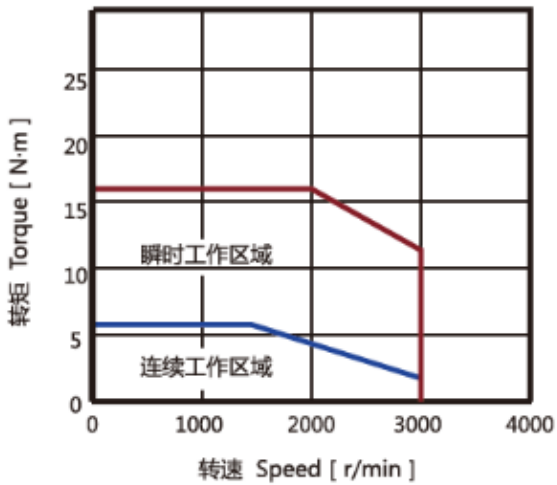

— Max TN & flux weakening
 — S1 Continuous TN

Model	Frame Size	Name	Power (KW)	Motor Length (mm)	Shaft Diameter (mm)	Shaft End Spec.(mm)			
						Keyway Width	Keyway Length	Keyway Depth	Screw Thread
S08-AM5-40□-H1	130	AM5	0.85	128.5	19	5	25	5	M5*16
S08-AM5-40B□-H1				164.5		5	25	5	M5*16

• S08 – AM7-25□-H2

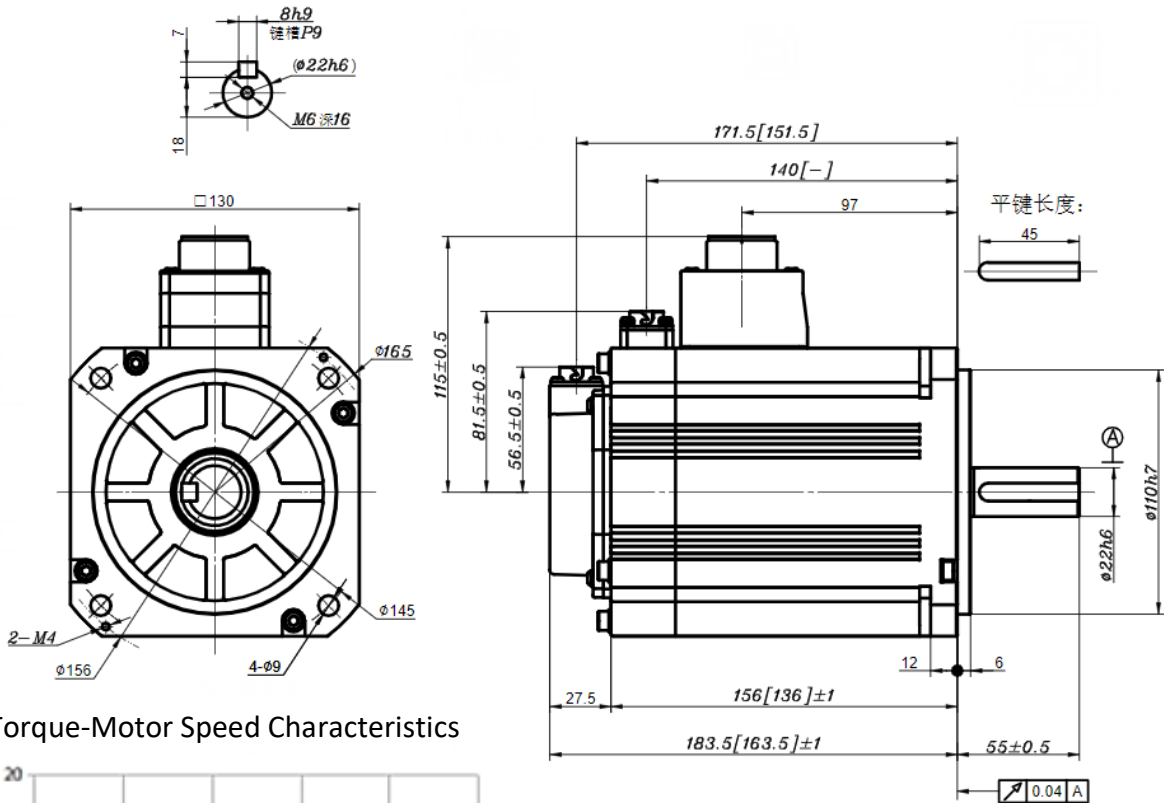

Torque-Motor Speed Characteristics

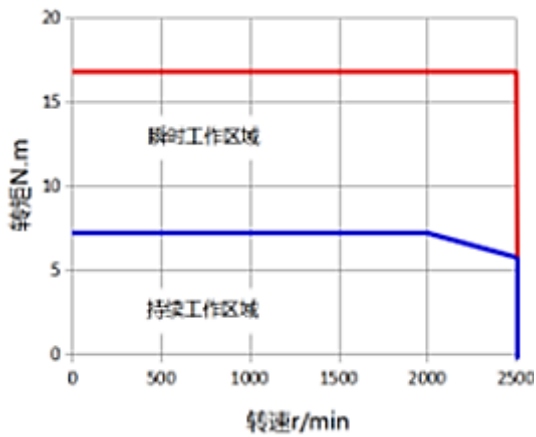

— Max TN & flux weakening
 — S1 Continuous TN

Model	Frame Size	Name	Power (KW)	Motor Length (mm)	Shaft Diameter (mm)	Shaft End Spec.(mm)			
						Keyway Width	Keyway Length	Keyway Depth	Screw Thread
S08-AM7-25□-H2	130	AM7	1.5	163.5	22	8	45	4	M6*16
S08-AM7-25B□-H2				183.5		8	45	4	M6*16

• S08 – AM7-30□-H2

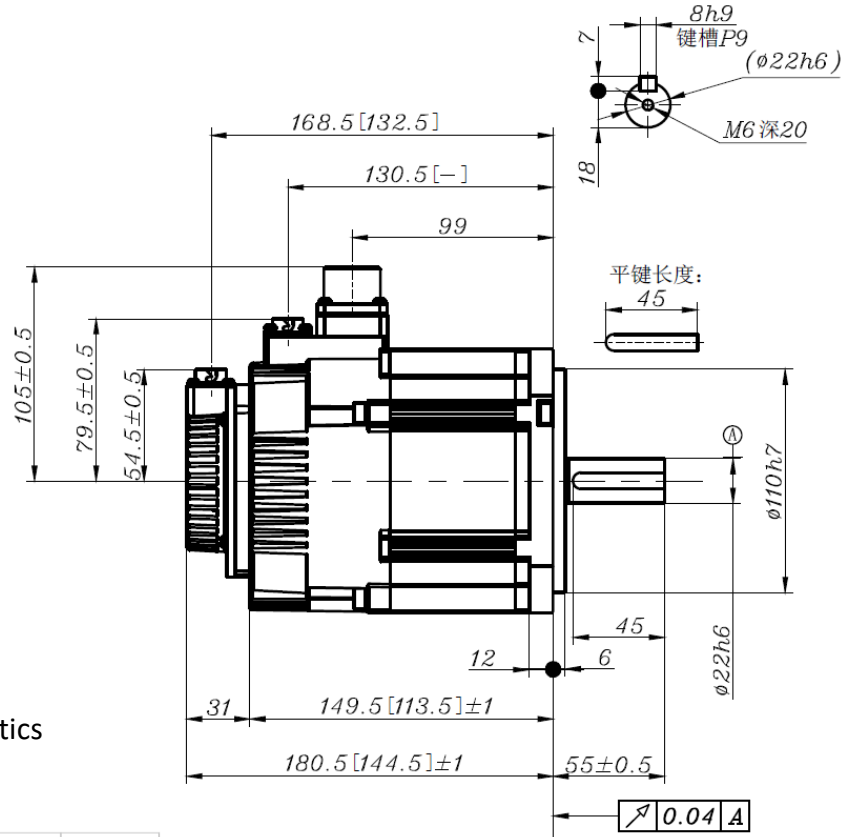
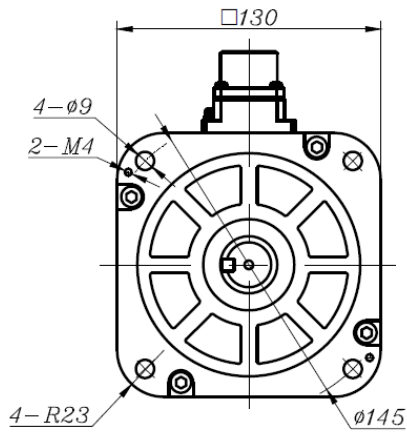

Torque-Motor Speed Characteristics

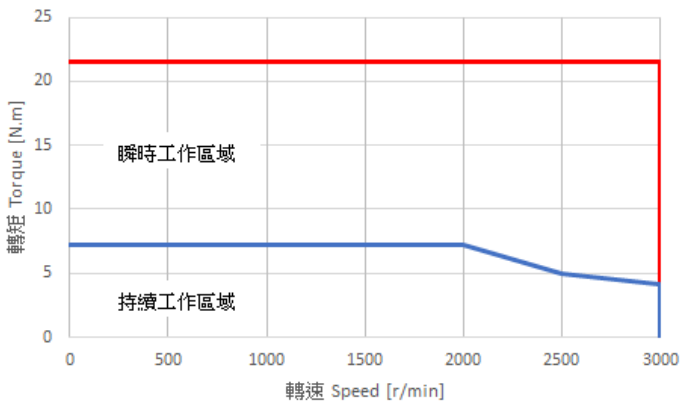

— Max TN & flux weakening
 — S1 Continuous TN

Model	Frame Size	Name	Power (KW)	Motor Length (mm)	Shaft Diameter (mm)	Shaft End Spec.(mm)			
						Keyway Width	Keyway Depth	Keyway Length	Screw Thread
S08-AM7-30□-H2	130	AM7	1.5	144.5	22	8	4	45	M6*20
S08-AM7-30B□-H2				180.5		8	4	45	M6*20

• S08 – AM8-30□-H1

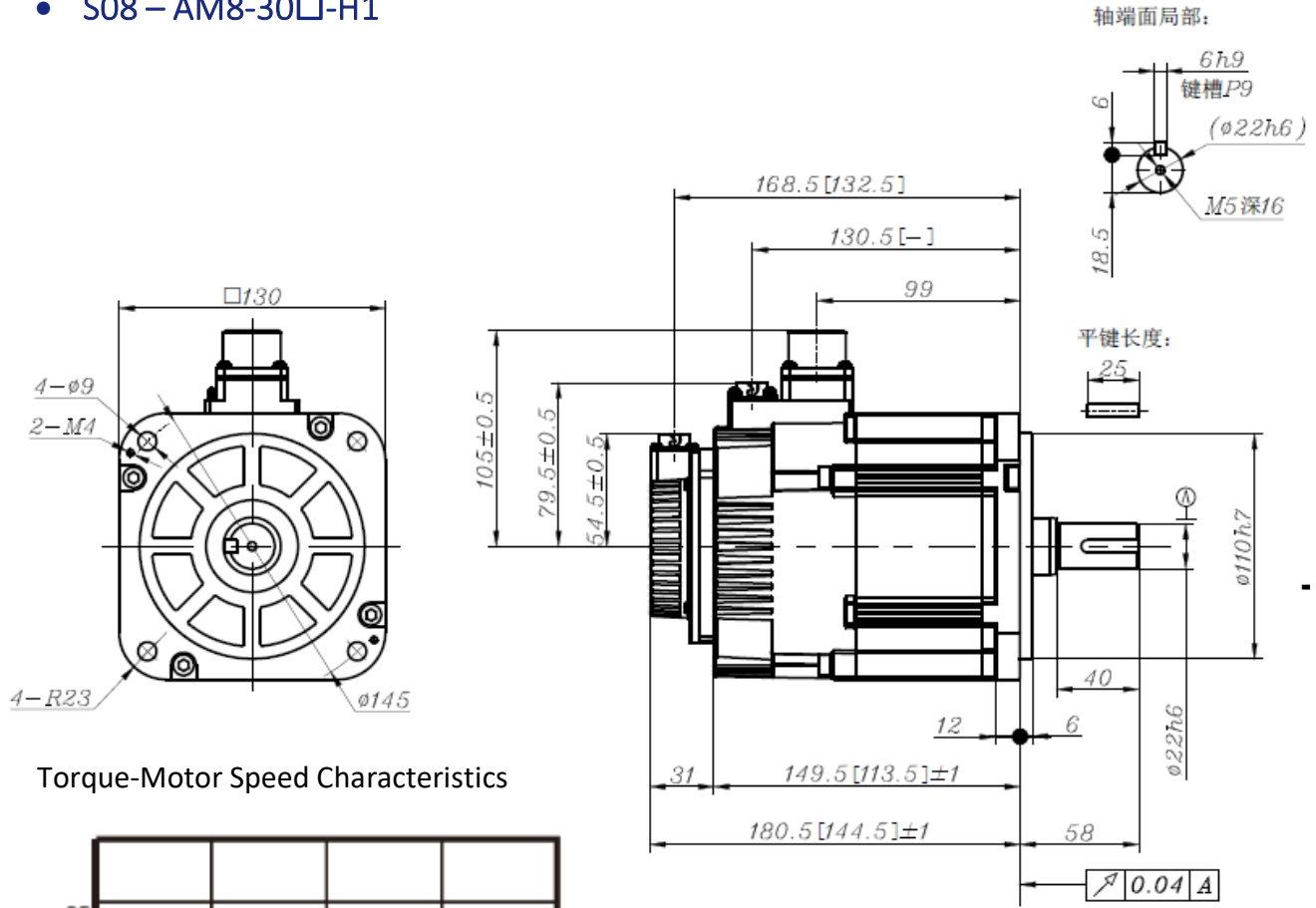

Torque-Motor Speed Characteristics

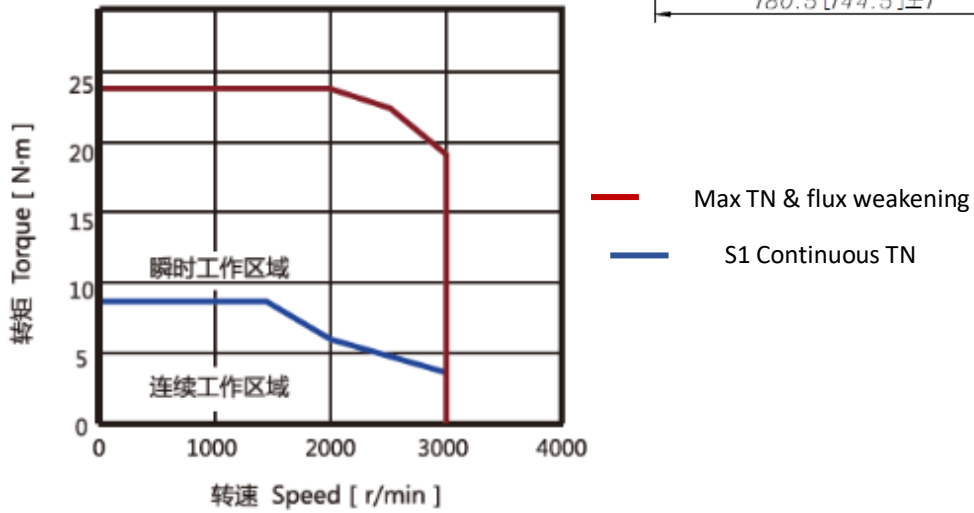

Model	Frame Size	Name	Power (KW)	Motor Length (mm)	Shaft Diameter (mm)	Shaft End Spec.(mm)			
						Keyway Width	Keyway Length	Keyway Depth	Screw Thread
S08-AM8-30□-H1	130	AM8	1.3	144.5	22	6	25	6	M5*16
S08-AM8-30B□-H1				180.5		6	25	6	M5*16

• S08 – AM9-30□-H2

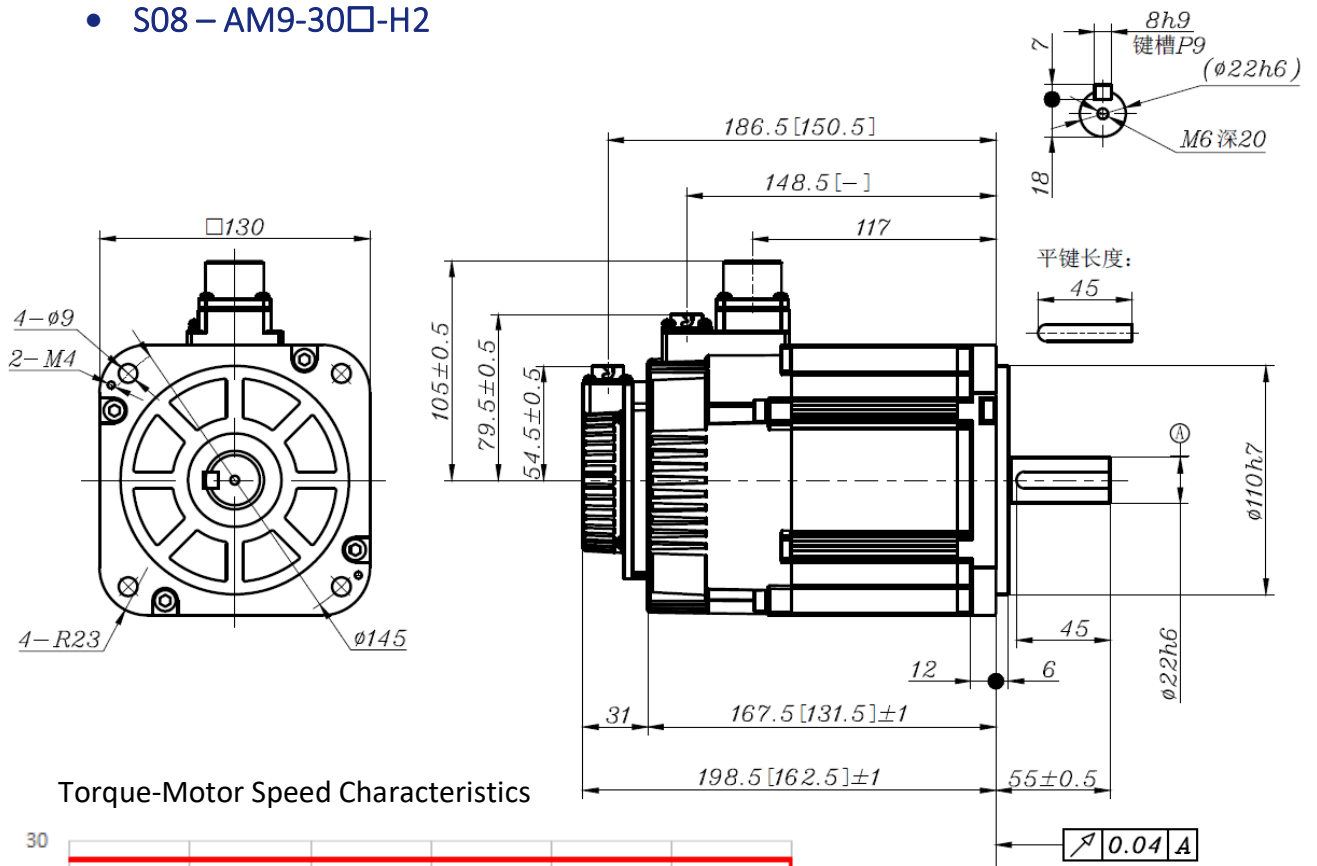

Torque-Motor Speed Characteristics

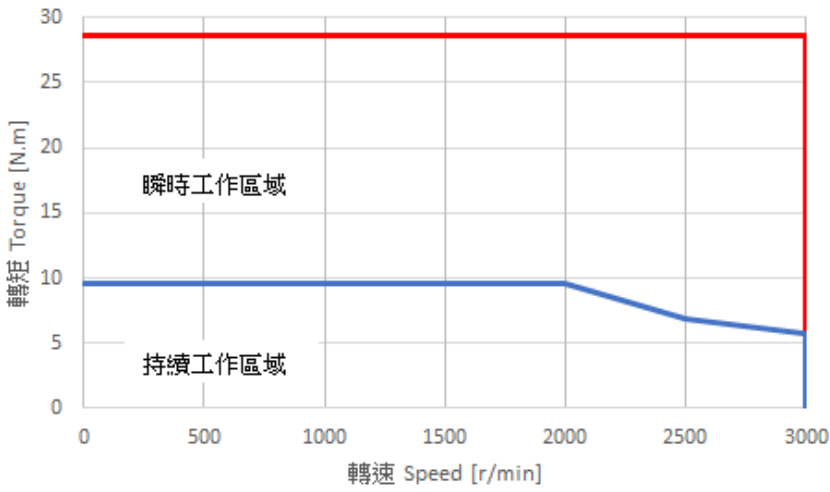

— Max TN & flux weakening
 — S1 Continuous TN

Model	Frame Size	Name	Power (KW)	Motor Length (mm)	Shaft Diameter (mm)	Shaft End Spec.(mm)			
						Keyway Width	Keyway Length	Keyway Depth	Screw Thread
S08-AM9-30□-H2	130	AM9	2	162.5	22	8	45	4	M6*20
S08-AM9-30B□-H2				198.5		8	45	4	M6*20

• S08 – AM11-30□-H1

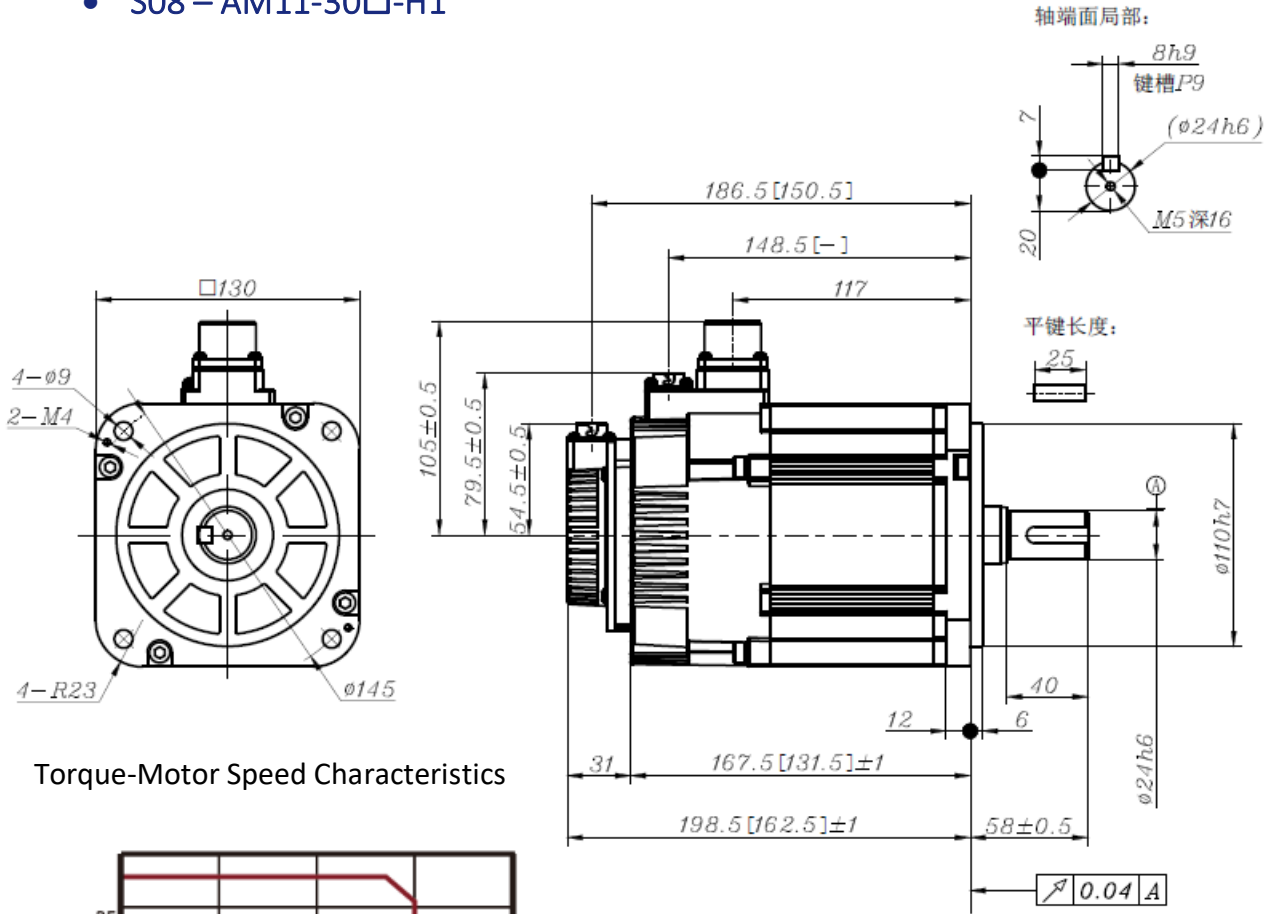

Torque-Motor Speed Characteristics

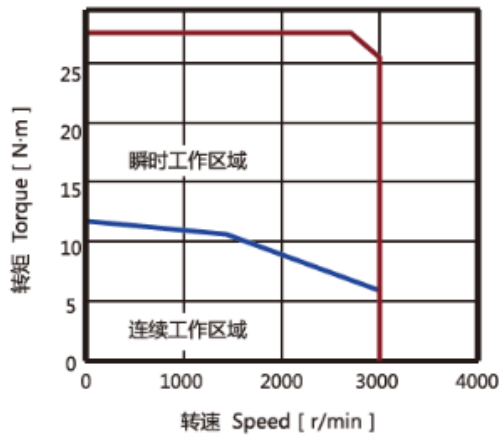

— Max TN & flux weakening
 — S1 Continuous TN

Model	Frame Size	Name	Power (KW)	Motor Length (mm)	Shaft Diameter (mm)	Shaft End Spec.(mm)			
						Keyway Width	Keyway Depth	Keyway Length	Screw Thread
S08-AM11-30□-H1	130	AM11	1.8	162.5	24	8	7	25	M5*16
S08-AM11-30B□-H1				198.5		8	7	25	M5*16

Table of Motors and Applicable Drive

220V Class

○ H Series

220V Axial Motor					Drive		
Model Number	Encoder	Frame Size	Shaft Diameter	Optional	Single-axis Servo Drive II	Multi-axis Servo Drive	
S08-AM□□ - □□□ - □□		mm	mm	B: Break K: Keyway BK: Break+Keyway			
Protex Level IP65							
H Series	Hcfa 17bit	AM03-50□-H1	40	8	B,BK	SVD22C1-010 (380V)SVD32 C1-020	SMD-30/30-XS SMD-30/30/30-XS SMD-30/30/30/30-XS SMD-30/30/30/30-M SCD-□□-30/30/30/30-M (380V)SMH-25/25-75-M(Axial) (380V)SMH-25/25/35-75-XL(Axial)
		AM03-50B□-H1	40	8			
		AM06-50□-H1	60	14			
		AM06-50B□-H1	60	14			
		AM1-50□-H1	60	14			
		AM1-50B□-H1	60	14			
		AM1-50□-H2	60	14			
		AM1-50B□-H2	60	14			
		AM2-50□-H1	80	19			
		AM2-50B□-H1	80	19			
		AM2-50□-H2	80	19			
		AM2-50B□-H2	80	19			
		AM4-40□-H2	130	22			
		AM4-40B□-H2	130	22			
		AM7-30□-H2	130	22			
		AM7-30B□-H2	130	22			
		AM9-30□-H2	130	22			
AM9-30B□-H2	130	22					
Protex Level IP67							
H Series	Hcfa 17bit	AM03-50□-H3	40	8	B,BK	SVD22C1-010 (380V)SVD32 C1-020	SMD-30/30-XS SMD-30/30/30-XS SMD-30/30/30/30-XS SMD-30/30/30/30-M SCD-□□-30/30/30/30-M (380V)SMH-25/25-75-M(Axial) (380V)SMH-25/25/35-75-XL(Axial)
		AM03-50B□-H3	40	8			
		AM06-50□-H3	60	14			
		AM06-50B□-H3	60	14			
		AM1-50□-H3	60	14			
		AM1-50B□-H3	60	14			
		AM02-50□-H3	80	19			
		AM02-50B□-H3	80	19			
		AM7-25□-H2	130	22			
		AM7-25B□-H2	130	22			
		Protex Level IP67					
Protex Level IP67							
Protex Level IP67							

Cable (Machining)

220V Axial Motor		Optional Parts		
Model Number		Cable (Machining)		
S08-AM□□ - □□□ - □□		Power Cable	Encoder Cable	Brake Cable
 Protec Level IP65 				
H Series	AM03-50□-H1	AMLP power cable with AMP connector W01-AML-AMP-PM-□M	AMLP encoder cable with AMP connector W01-AML-AMP-EN6-□M	AMLP brake cable with AMP connector W01-AML-AMP-BK-□M
	AM03-50B□-H1			
	AM06-50□-H1			
	AM06-50B□-H1			
	AM1-50□-H1			
	AM1-50B□-H1			
	AM1-50□-H2			
	AM1-50B□-H2			
	AM2-50□-H1			
	AM2-50B□-H1			
	AM2-50□-H2			
	AM2-50B□-H2			
	AM4-40□-H2			
	AM4-40B□-H2			
	AM7-30□-H2			
	AM7-30B□-H2			
AM9-30□-H2				
AM9-30B□-H2				
 Protec Level IP67 				
H Series	AM03-50□-H3	AMLP power cable with water-proof connector W01-P-IP-PW-□M	AMLP encoder cable with water-proof connector W01-P-IP-EN6-□M	AMLP power brake cable with water-proof connector W01-I-IP-PWBK-□M
	AM03-50B□-H3			
	AM06-50□-H3			
	AM06-50B□-H3			
	AM1-50□-H3			
	AM1-50B□-H3			
	AM02-50□-H3			
	AM02-50B□-H3			
	AM7-25□-H2			
	AM7-25B□-H2			

Cable (Robot)

220V Axial Motor		Optional Parts		
Model Number		Cable (Robot)		
S08-AM□□ - □□□ - □□		Power Cable	Encoder Cable	Brake Cable
Protec Level IP65				
H Series	AM03-50□-H1	AMLP power cable with AMP connector-Robot W01-AML-AMP-PM-□M	AMLP encoder cable with AMP connector-Robot W01-AML-AMP-EN6-□M	AMLP brake cable with AMP connector W01-AML-AMP-BK-□M
	AM03-50B□-H1			
	AM06-50□-H1			
	AM06-50B□-H1			
	AM1-50□-H1			
	AM1-50B□-H1			
	AM1-50□-H2			
	AM1-50B□-H2			
	AM2-50□-H1			
	AM2-50B□-H1			
	AM2-50□-H2			
	AM2-50B□-H2			
	AM4-40□-H2	AM5~15 power cable with mini MIL-STD connector-Robot W01-AMR-MS-PW-□M	AM3~48 encoder cable with MIL-STD connector-Robot W01-AMR-M-EN6-□M	AM3~48 brake cable with MIL-STD connector-Robot W01-AM-M-BK-□M
	AM4-40B□-H2			
	AM7-30□-H2			
	AM7-30B□-H2			
	AM9-30□-H2			
	AM9-30B□-H2			

380V Class

○ F Series

380V Axial Motor					Drive			
Model Number	Encoder	Frame Size	Shaft Diameter	Optional	Single-axis Servo Drive II	Multi-axis Servo Drive		
S08-AM□□ - □□□ - □□		mm	mm	B: Break K: Keyway BK: Break+Keyway				
F Series	AM3-60□-F4	Nikon 24 bit	90	19	B,K,BK	SVD32C1-020	SMD-33B-2575(Axial) SMD-34B-2550(Axial)	
	AM3-60B□-F4		90	19				
	AM5-40□-F3		130	19				
	AM5-40B□-F3		130	19				
	AM8-40□-F3		130	22				
	AM8-40B□-F3		130	22				
	AM11-40□-F3		130	24	-	SPD32E1-050	SMD-33B-35100 (Axial) SMD-34B-3575(Axial)	
	AM11-40□-F3		130	24				
	AM11-30B□-F4		130	24	-	SPD32E1-050	SMD-34B-50150(Axial)	
	AM15-40□-F3		130	24				
	AM15-40B□-F3		130	24	B,K,BK	SPD32E1-050	-	
	AM18-40□-F4		180	35				
	AM18-40B□-F4		180	35	-	SPD32E1-110	-	
	AM18-30B□-F4		180	35				
	AM28-30□-F4		180	35	xx	B,K,BK	SPD32E1-110	-
	AM28-30B□-F4		180	35				
	AM35-20□-F4		180	42				
	AM35-20B□-F4		180	42				
	AM35-20□-F5		180	35				
	AM35-20B□-F5		180	35				
AM48-20□-F4	180	42						
AM48-20B□-F4	180	42						
AM48-20□-F5	180	35						
AM48-20B□-F5	180	35						
F series (Unit-Head)	AM8-50K-F1	Syntec 18 bit	130	22	-	SVD32C1-020	SMD-33B-35100 (Axial) SMD-34B-3575(Axial)	
	AM11-50K-F1		130	24		SPD32E1-050	-	

Cable (Machining)

380V Axial Motor		Optional Parts		
Model Number		Cable (Machining)		
S08-AM□□ - □□□ - □□		Power Cable	Encoder Cable	Brake Cable
F Series	AM3-60□-F4	AM03~3 power cable with MC connector W01-AM-MC-PW-□M		
	AM3-60B□-F4			
	AM5-40□-F3	AM5~15 power cable with MC connector W01-AM-MC-PW-□M		
	AM5-40B□-F3			
	AM8-40□-F3			
	AM8-40B□-F3			
	AM11-40□-F3			
	AM11-40□-F3			
	AM11-30B□-F4			
	AM15-40□-F3			
	AM15-40B□-F3	AM18~48 power cable with mini MIL-STD connector W01-AM-MS-PW-□M		
	AM18-40□-F4			
	AM18-40B□-F4			
	AM18-30B□-F4			
	AM28-30□-F4			
	AM28-30B□-F4			
	AM35-20□-F4			
	AM35-20B□-F4			
	AM35-20□-F5			
	AM35-20B□-F5			
AM48-20□-F4				
AM48-20B□-F4				
AM48-20□-F5				
AM48-20B□-F5				
F Series (Unit-Head)	AM8-50K-F1	AM5~15 power cable with MC connector W01-AM-MC-PW-□M	AM3~48 encoder cable with MIL-STD connector W01-AM-M-EN6-□M	AM3~48 brake cable with MIL-STD connector W01-AM-M-BK-□M
	AM11-50K-F1			

Cable (Robot)

380V Axial Motor		Optional Parts			
Model Number		Cable (Robot)			
S08-AM□□ - □□□ - □□		Power Cable	Encoder Cable	Brake Cable	
F Series	AM3-60□-F4	AM03~3 power cable with MC connector-Robot W01-AMR-MC-PW-□M			
	AM3-60B□-F4				
	AM5-40□-F3	AM5~15 power cable with MC connector-Robot W01-AR-MC-PW-□M			
	AM5-40B□-F3				
	AM8-40□-F3				
	AM8-40B□-F3				
	AM11-40□-F3				
	AM11-40□-F3				
	AM11-30B□-F4				
	AM15-40□-F3				
	AM15-40B□-F3				AM18~48 power cable with mini MIL-STD connector-Robot W01-AMR-MS-PW-□M
	AM18-40□-F4				
	AM18-40B□-F4				
	AM18-30B□-F4				
	AM28-30□-F4				
	AM28-30B□-F4				
	AM35-20□-F4				
	AM35-20B□-F4				
	AM35-20□-F5				
	AM35-20B□-F5				
AM48-20□-F4					
AM48-20B□-F4					
AM48-20□-F5					
AM48-20B□-F5					
F Series (Unit-Head)	AM8-50K-F1	-	-	-	
	AM11-50K-F1	-	-	-	

○ Z series

380V Axial Motor					Drive		
Model Number	Encoder	Frame Size	Shaft Diameter	Optional	Single-axis Servo Drive II	Multi-axis Servo Drive	
S08-AM□□ - □□□ - □□		mm	mm	B: Break K: Keyway BK: Break+Keyway			
Z series	AM03-50□-Z3	Nikon 24 bit	40	8	B,K,BK	SVD22C1-010 (380V)SVD32C1-020	SMD-24A-2020 SCD-□□-24A-2020 SMD-2□B-2020 (380V)SMD-33B-2575(Axial) (380V)SMD-34B-2550(Axial)
	AM03-50B□-Z3		40	8			
	AM06-50□-Z3		60	14			
	AM06-50B□-Z3		60	14			
	AM1-60□-Z4		60	14			
	AM1-60B□-Z4		60	14			
	AM1-50□-Z3		60	14			
	AM1-50B□-Z3		60	14			
	AM2-60□-Z4		80	19			
	AM2-60B□-Z4		80	19			
	AM3-50□-Z3		80	19			
	AM3-50B□-Z3		80	19			

Cable (Machining)

380V Axial Motor		Optional Parts		
Model Number		Cable (Machining)		
S08-AM□□ - □□□ - □□		Power Cable	Encoder Cable	Brake Cable
Z series	AM03-50□-Z3	AM03~3 power cable with MC connector W01-AM-MC-PW-□M	AM03~3 encoder cable with MIL-STD connector W01-AM-M-EN6-□M	AM03~3 brake cable with MIL-STD connector W01-AM-M-BK-□M
	AM03-50B□-Z3			
	AM06-50□-Z3			
	AM06-50B□-Z3			
	AM1-60□-Z4			
	AM1-60B□-Z4			
	AM1-50□-Z3			
	AM1-50B□-Z3			
	AM2-60□-Z4			
	AM2-60B□-Z4			
	AM3-50□-Z3			
	AM3-50B□-Z3			

Cable (Robot)

380V Axial Motor		Optional Parts		
Model Number		Cable (Robot)		
S08-AM□□ - □□□ - □□		Power Cable	Encoder Cable	Brake Cable
Z series	AM03-50□-Z3	AM03~3 power cable with MC connector-Robot W01-AMR-MC-PW-□M	AM03~3 encoder cable with MIL-STD connector-Robot W01-AMR-M-EN6-□M	AM03~3 brake cable with MIL-STD connector-Robot W01-AMR-M-BK-□M
	AM03-50B□-Z3			
	AM06-50□-Z3			
	AM06-50B□-Z3			
	AM1-60□-Z4			
	AM1-60B□-Z4			
	AM1-50□-Z3			
	AM1-50B□-Z3			
	AM2-60□-Z4			
	AM2-60B□-Z4			
	AM3-50□-Z3			
	AM3-50B□-Z3			